

 **Rolmako**

**TECHNICAL AND SALES**

**CATALOG**

**TILLAGE MACHINES**



Rolmako - Machinery and Parts for Agriculture, Plant No. 1- ul. Gwarna 8, Plant No. 2 - ul. Nekielska 11 F  
Psary Małe near Września, 62-300 Września, Wielkopolskie Province, Nip [TIN]: 789-000-20-53

## Table of Contents

page	
3	Machines on the front three-point linkage / Prismatic roller Orion / Option SOLO
4	Machines on the front three-point linkage / Steel ring roller / Option with two-row cultivator attachment
5	Machines on the front three-point linkage / Campbell roller/ Option with three-row cultivator attachment
6	Machines on the front three-point linkage / Crosskill roller / Option with straight mechanical drag
7	Machines on the front three-point linkage / TWIN-DISC roller / Option with the hydraulic drag Crossboard
8	Seedbed cultivator U 382
9	Seedbed cultivator U 659 / Two-row option
10	Seedbed cultivator U 659 / Three-row option
11	Compact seedbed cultivator U 684 / SU tine
12	Compact seedbed cultivator U 684 / Mounted option / SA tine
13	Compact seedbed cultivator U 684 / Mounted option / SG tine
14	Compact seedbed cultivator U 684 / Mounted option / SX tine
15	Compact seedbed cultivator U 684 / Semi-mounted option
16	Light disc harrow U 622 / Option with a spring comb behind the roller
17	Compact disc harrow U 693 / Option with a spring comb behind the roller
18	Compact disc harrow U 693 / Semi-mounted option
19	Disc harrow for vineyards and gardens U 645
20	Disc harrow U 652 / Mounted option / Shock absorber 3D
21	Disc harrow U 652 / Mounted option / Rubber shock absorber
22	Disc harrow U 652 / Semi-mounted option / Rubber shock absorber
23	Heavy stubble harrow U 671 / Mounted option
24	Heavy stubble harrow U 671 / Semi-mounted option / STANDARD
25	Heavy stubble harrow U 671 PRO / Semi-mounted option
26	Universal crop cultivator U 497 / Mounted option
27	Universal crop cultivator U 497 / Semi-mounted option
28	Stubble cultivator U 453
29	Multifunctional tillage cultivator U 436 / Mounted option
30	Multifunctional tillage cultivator U 436 / Mounted option / Hydraulically folded
31	Multifunctional tillage cultivator U 436 PRO / Mounted option
32	Multifunctional tillage cultivator U 436 PRO / Semi-mounted option
33	Multifunctional tillage cultivator U 436 / Semi-mounted option
34	Universal subsoiler U 602
35	Subsoiler with a coupler U 608
36	Subsoiler with a V frame U 614
37	Subsoiler with two rows of tines U 619
38	Multi-purpose subsoiler U 638
39	Subsoiler with a coupler ATLAS U 632
40	Rollers for field leveling and soil lumps breaking

**We are at your disposal**  
on weekdays from 8.00 - 16.00

**Sales department:** tel. (+48) 61 438 87 35  
tel. (+48) 61 437 39 16  
e-mail: rolmako@rolmako.pl

**Bookkeeping** tel. (+48) 61 437 39 33  
e-mail: ksiegowosc@rolmako.pl

**Technical Support for dealers** Tomasz Kowalski  
tel. (+48) 61 437 39 31  
tel. (+48) 61 437 39 32  
mobile (+48) 608 479 817  
mobile (+48) 604 520 342  
e-mail: t.kowalski@rolmako.pl

### Online catalog of products

[www.katalog.rolmako.pl](http://www.katalog.rolmako.pl)  
[www.katalog.rolmako.com](http://www.katalog.rolmako.com)  
[www.katalog.rolmako.de](http://www.katalog.rolmako.de)  
[www.katalog.rolmako.fr](http://www.katalog.rolmako.fr)  
[www.katalog.rolmako.ru](http://www.katalog.rolmako.ru)

**Price-list in electronic option**  
[www.pricelist.rolmako.com](http://www.pricelist.rolmako.com)

**Technical and sales catalog in electronic option**  
[www.rolmako.com/technical-and-sales-catalog.pdf](http://www.rolmako.com/technical-and-sales-catalog.pdf)

**All dimensions and weights of the machines are subject to further technical development and therefore are not binding. We keep an option to change the prices, the construction of the machinery and the technical parameters.**

**[www.rolmako.com](http://www.rolmako.com)**

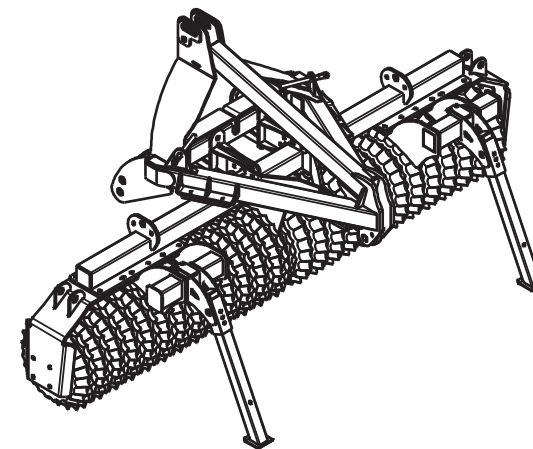
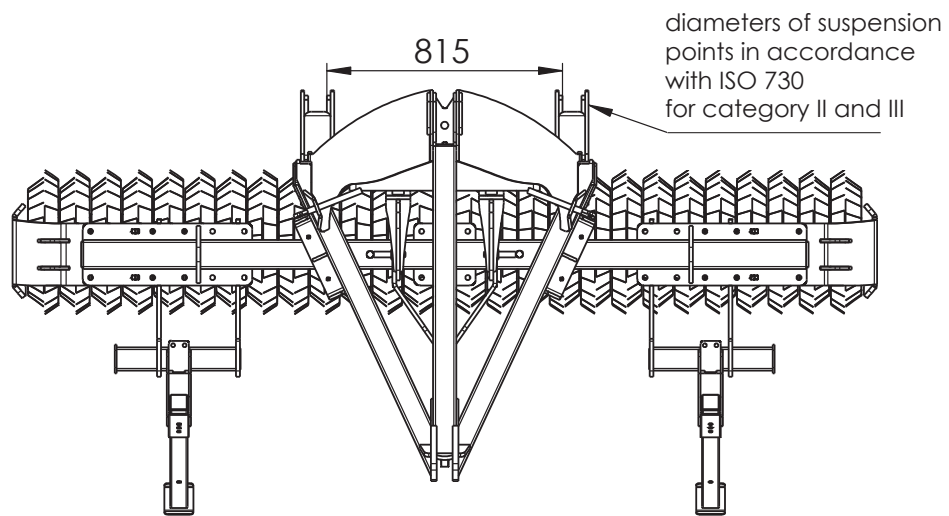
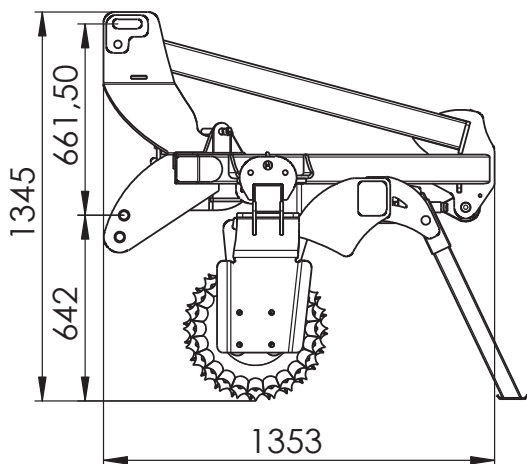

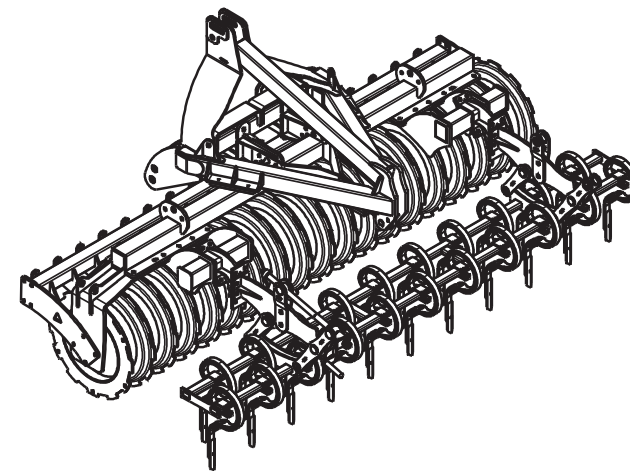
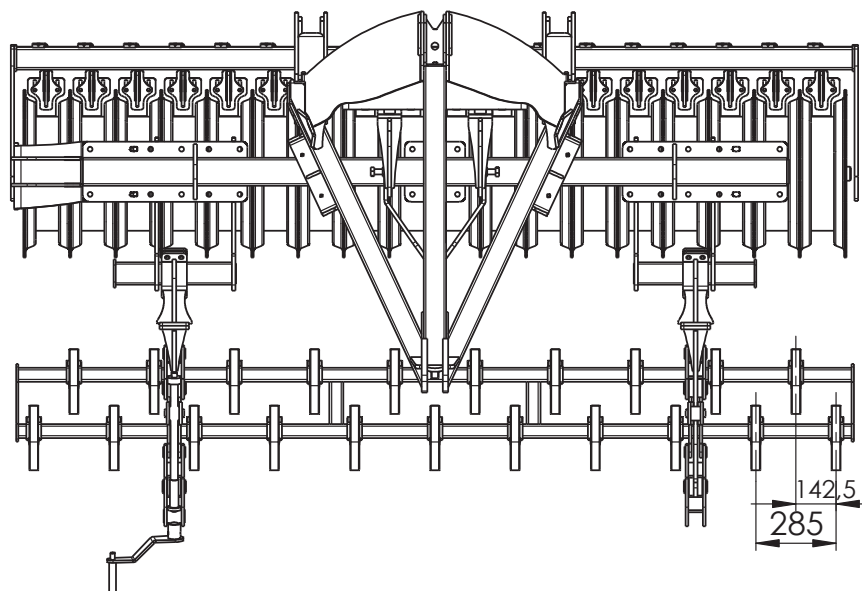
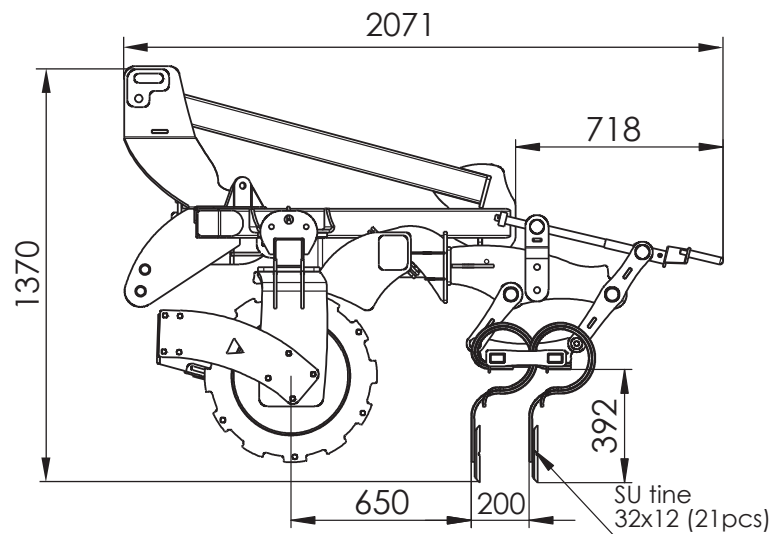

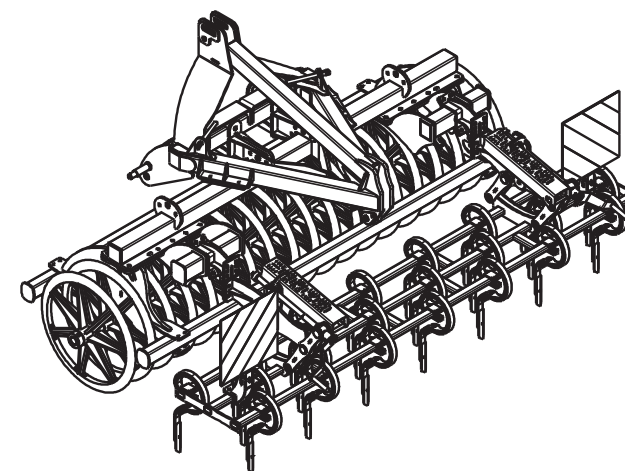
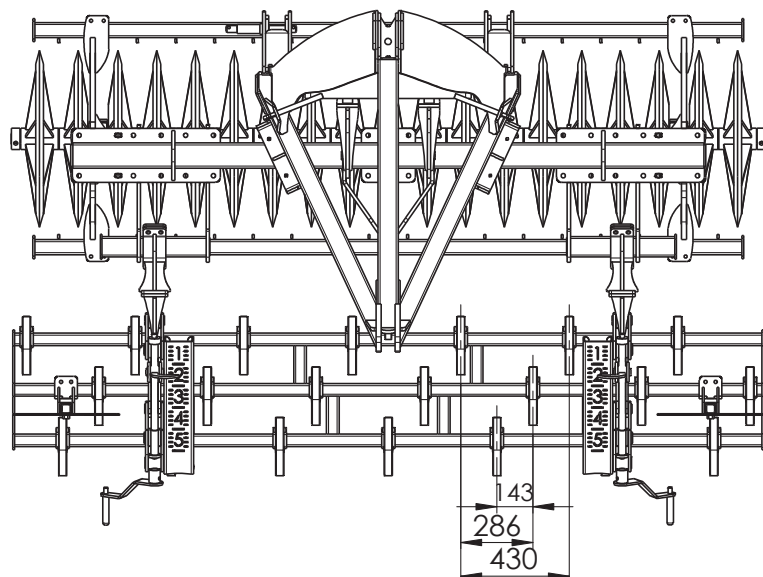
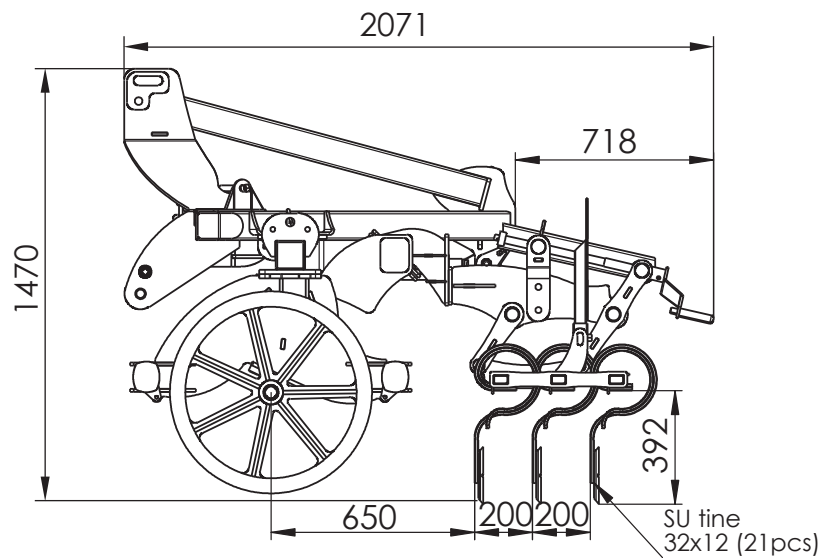

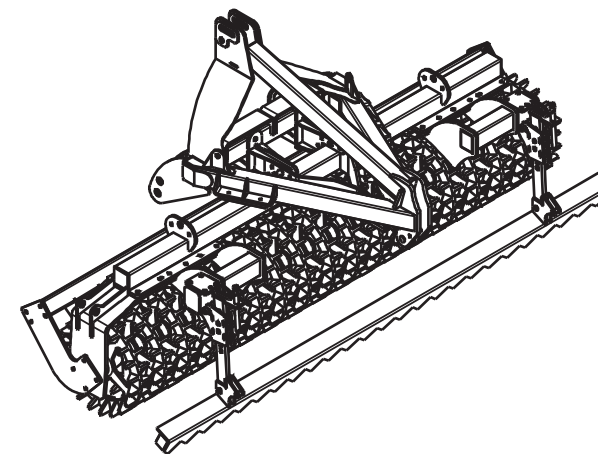
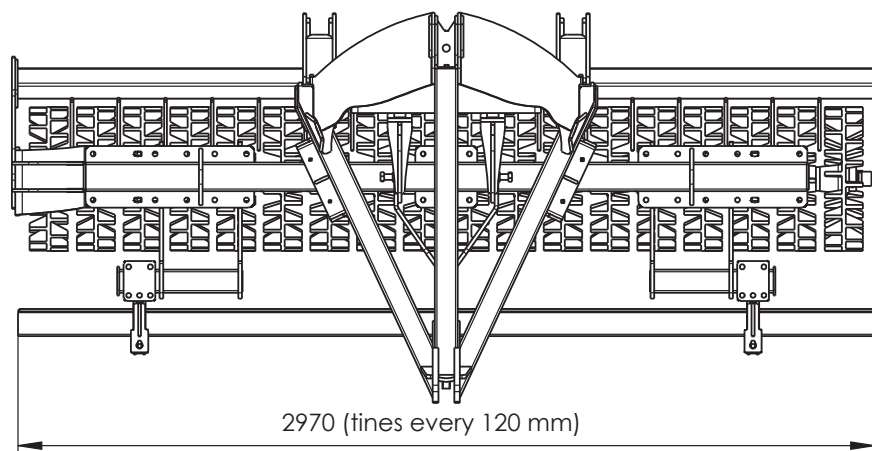
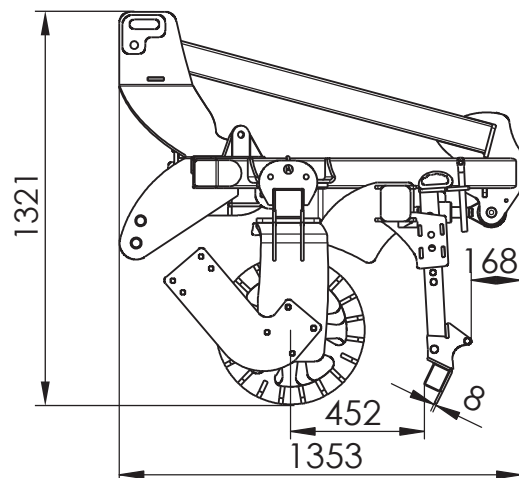

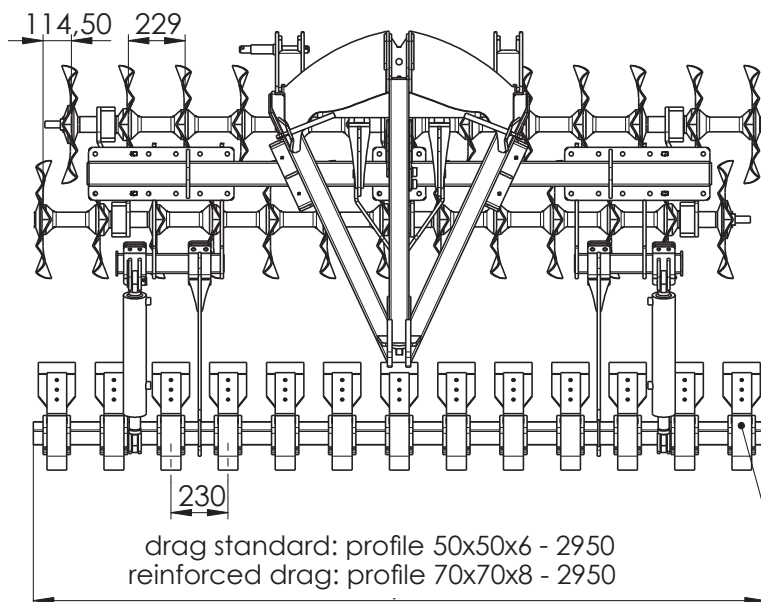
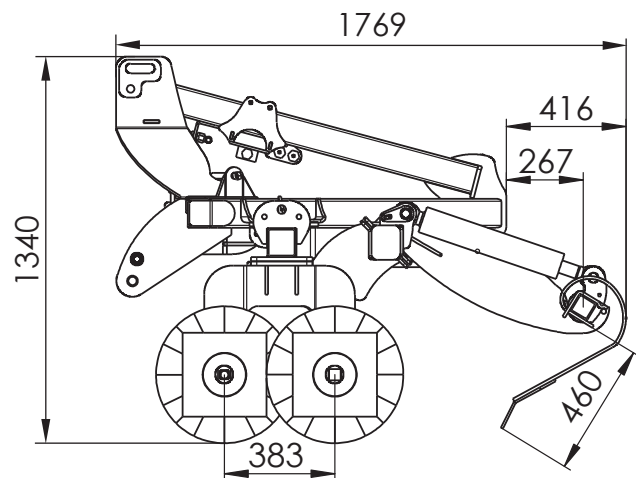

drag standard: profile 50x50x6 - 2950  
reinforced drag: profile 70x70x8 - 2950

- drag standard spring 45x10; runner 100 mm
- reinforced drag spring 80x10; runner 150 mm

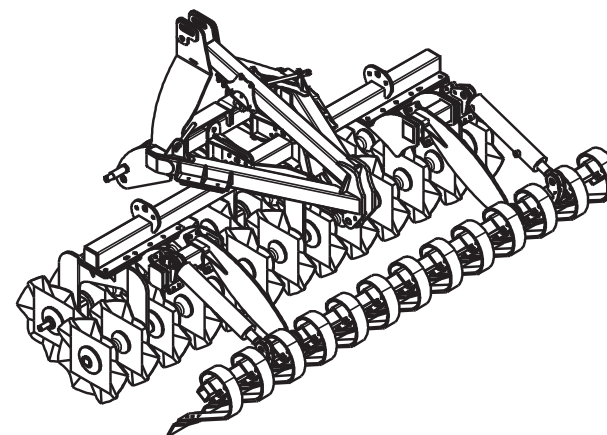

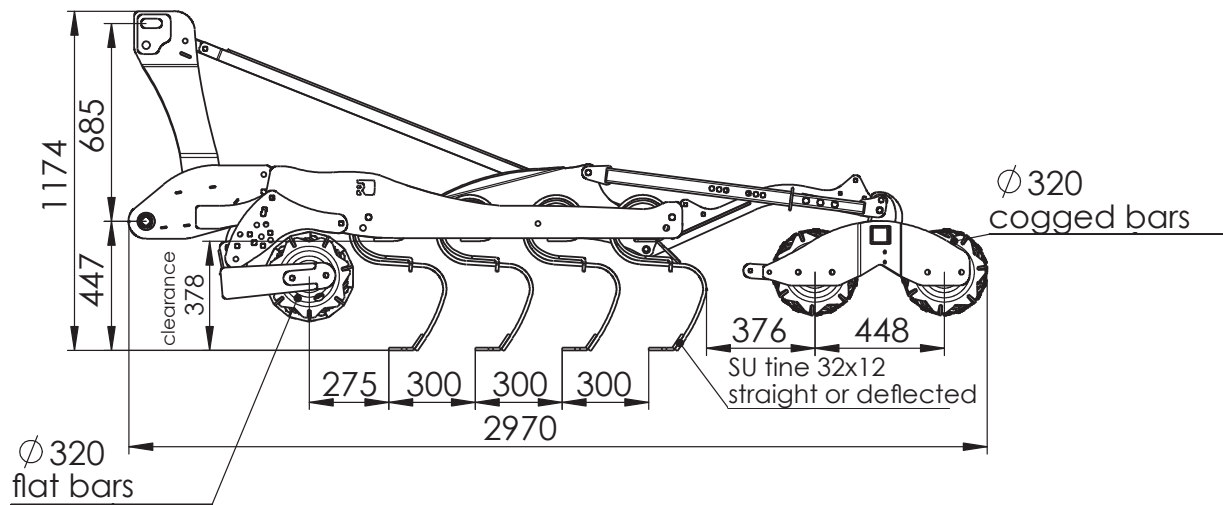

Diameters of the suspension points correspond to ISO 730 for:

- 3.0 m / 3.5 m / 4.0 m / 4.0 m H / 4.5 m H - cat. II and III
- 5.0 m H / 5.5 m H / 6.0 m H - cat. III

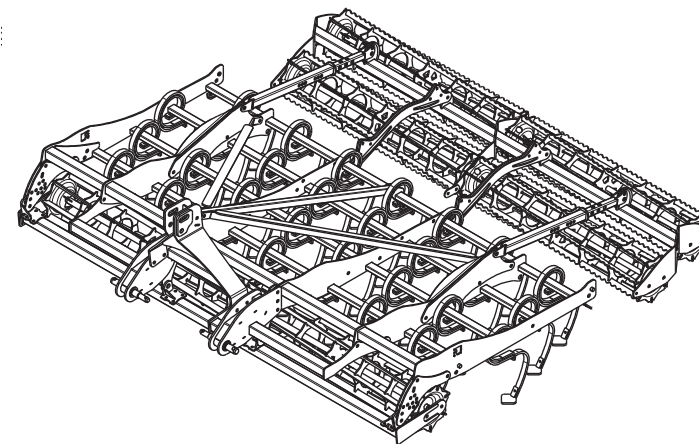
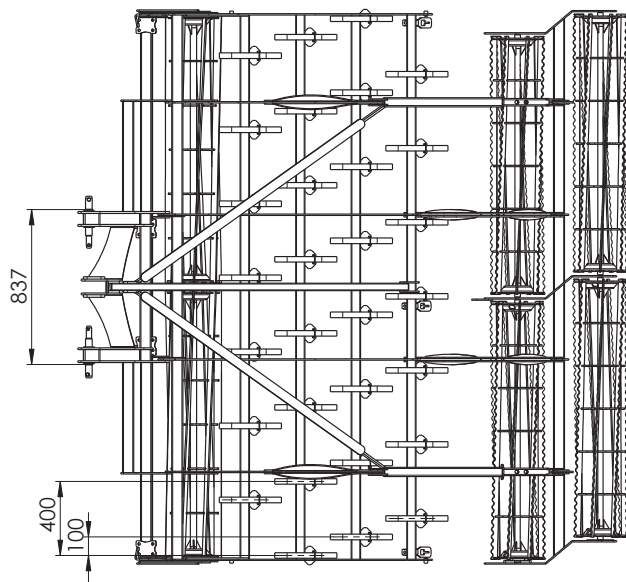



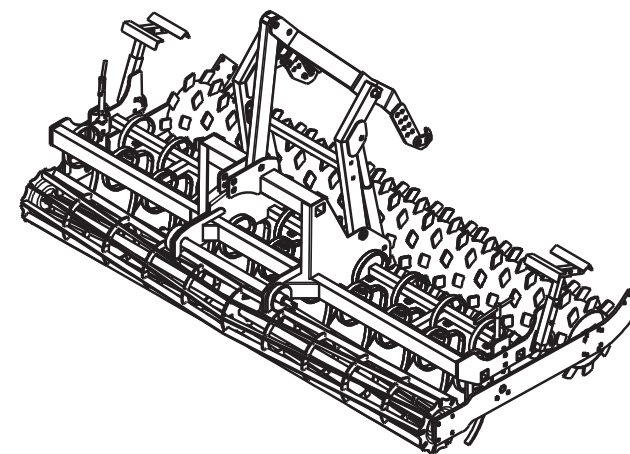
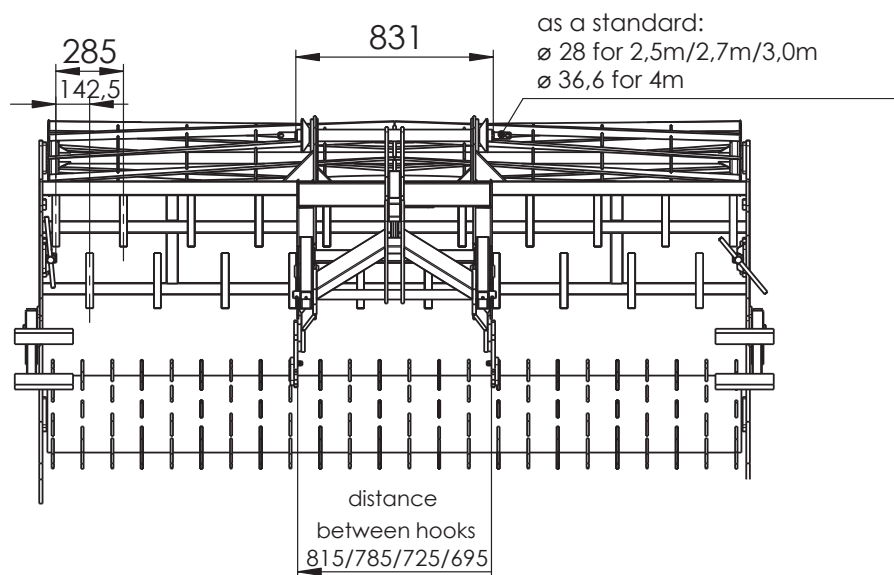
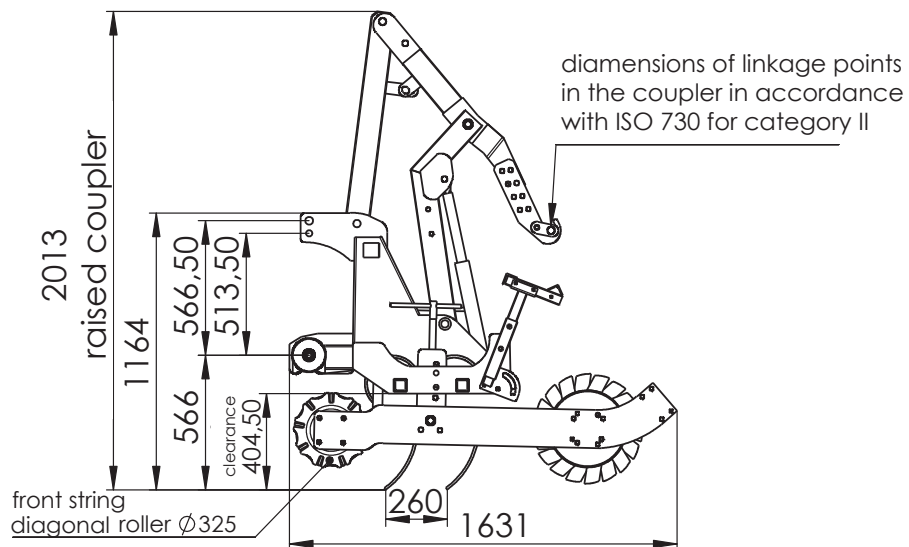

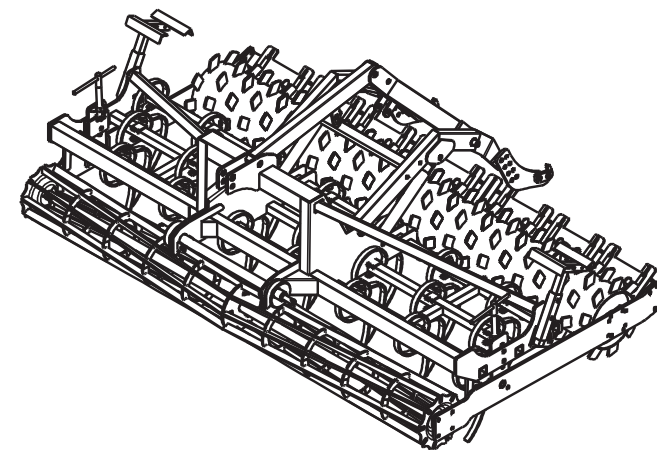
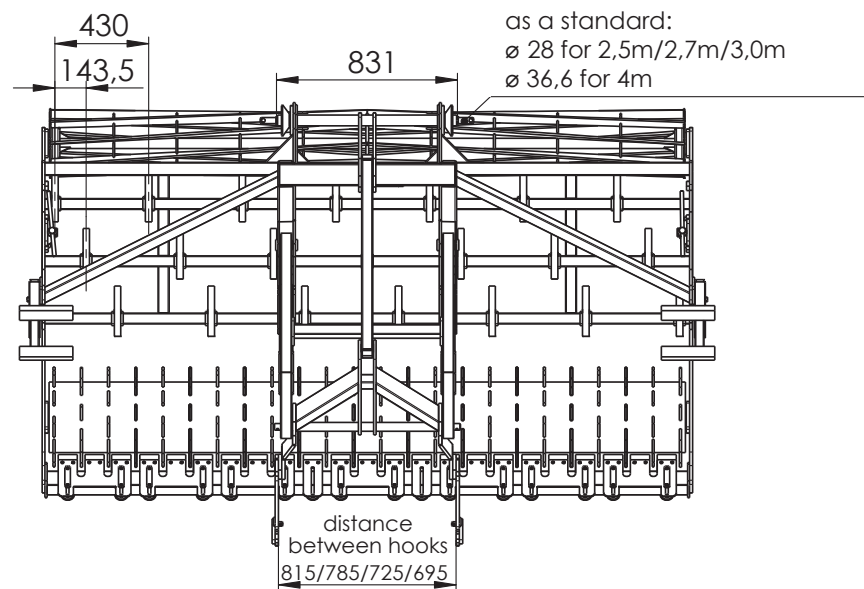
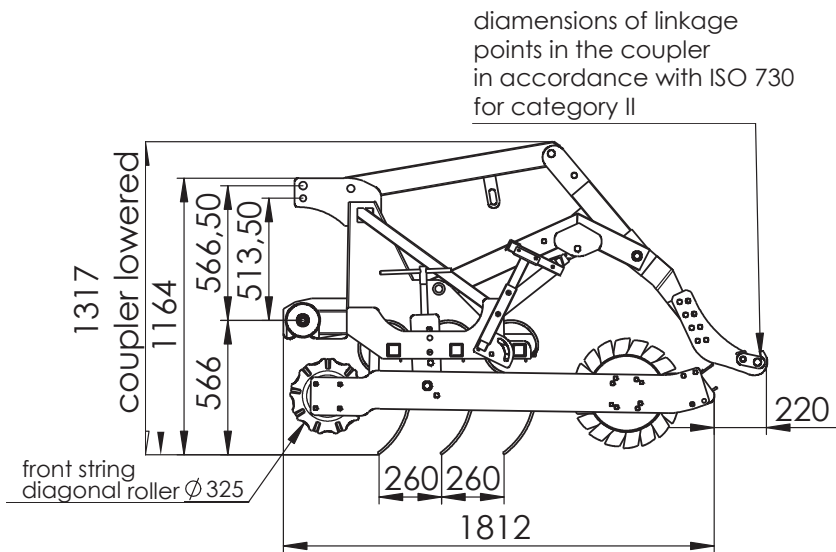

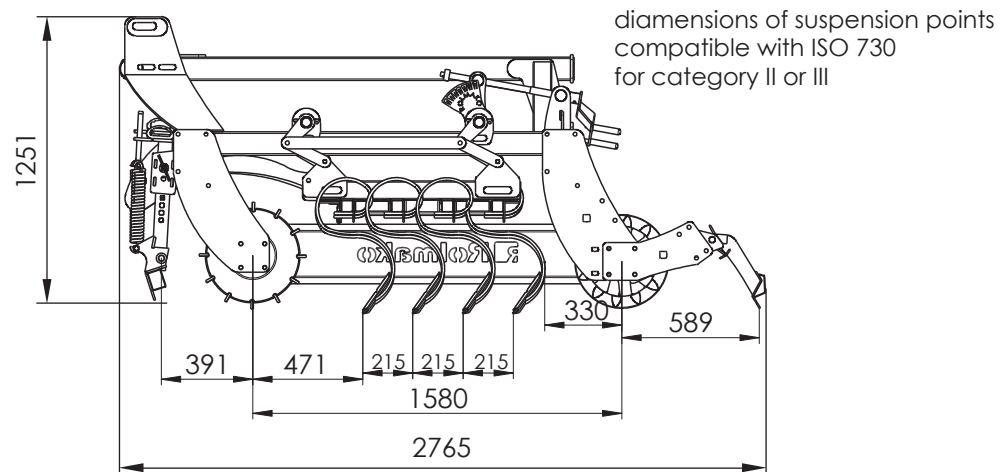

SU tine 32x12 mm with reinforcement, coulter 35x200x5 mm

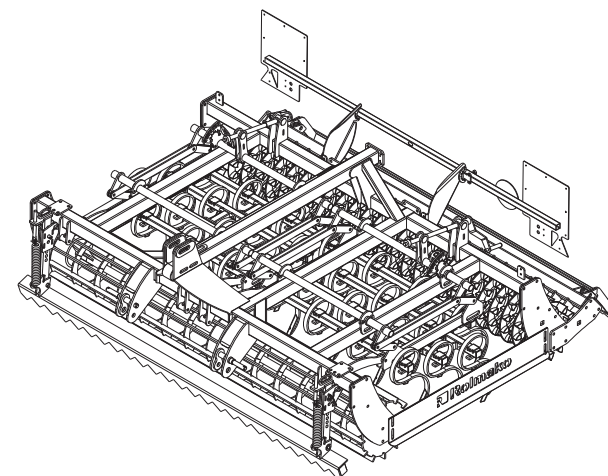
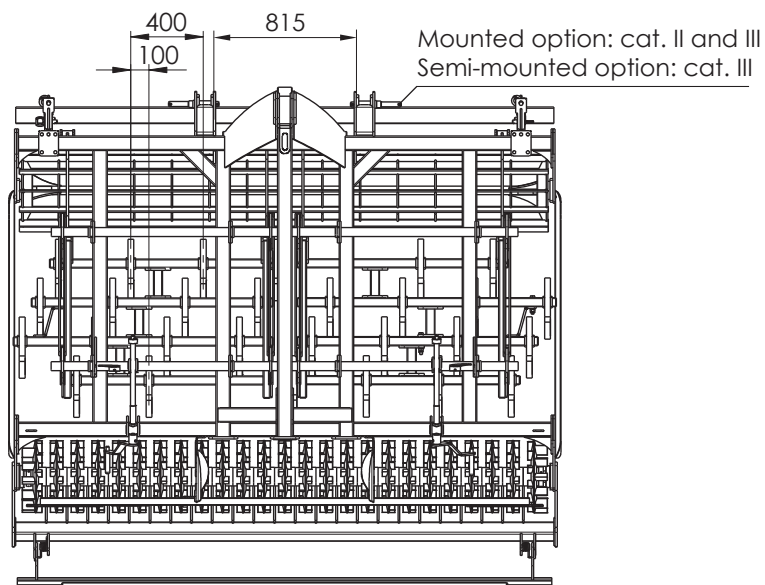
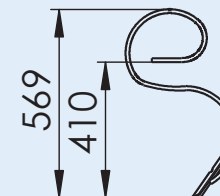

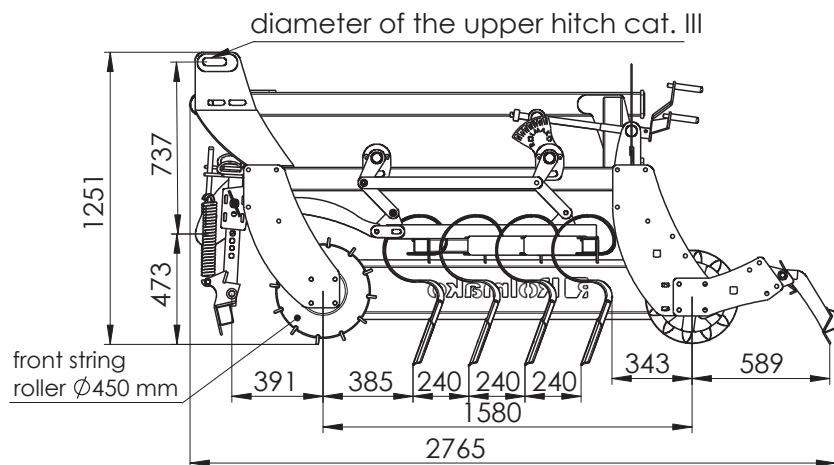

SA tine 45x12 mm, coulters 40x215x6 mm

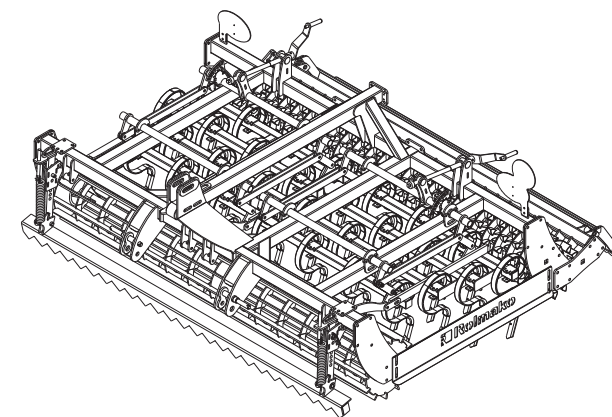
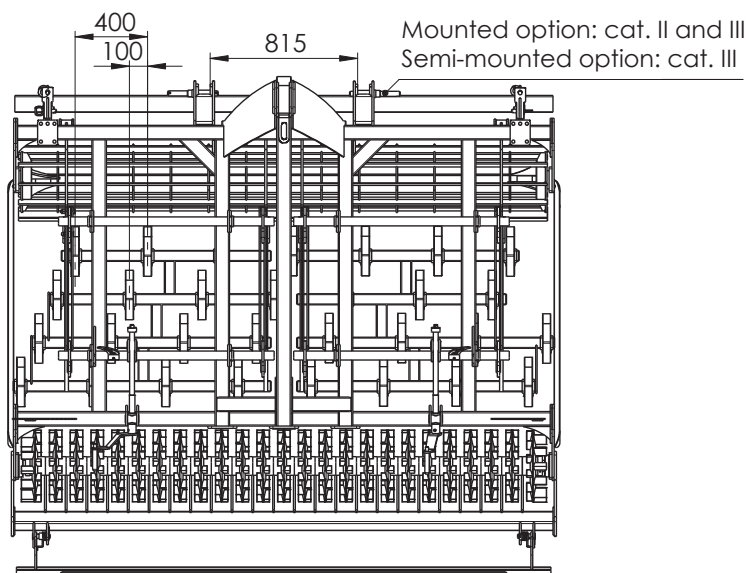
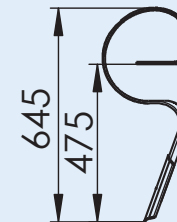

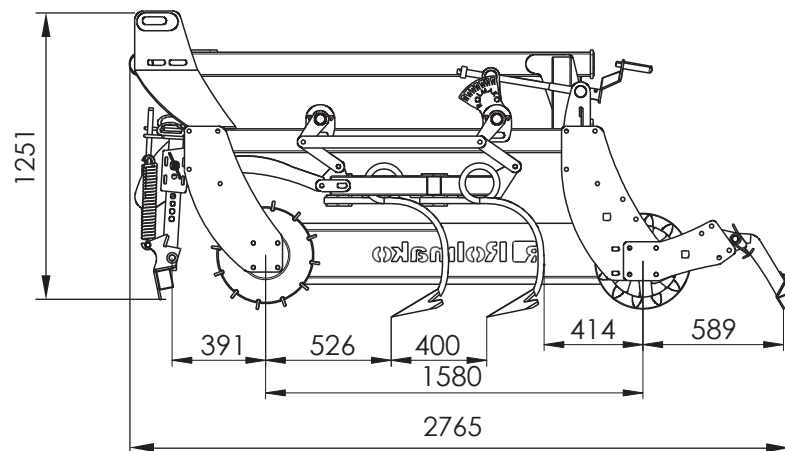

SG tine with spring beam 25x25 mm,  
coulters 260 mm wide

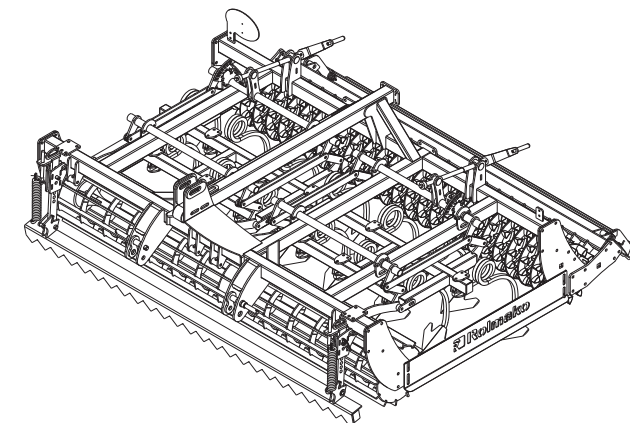
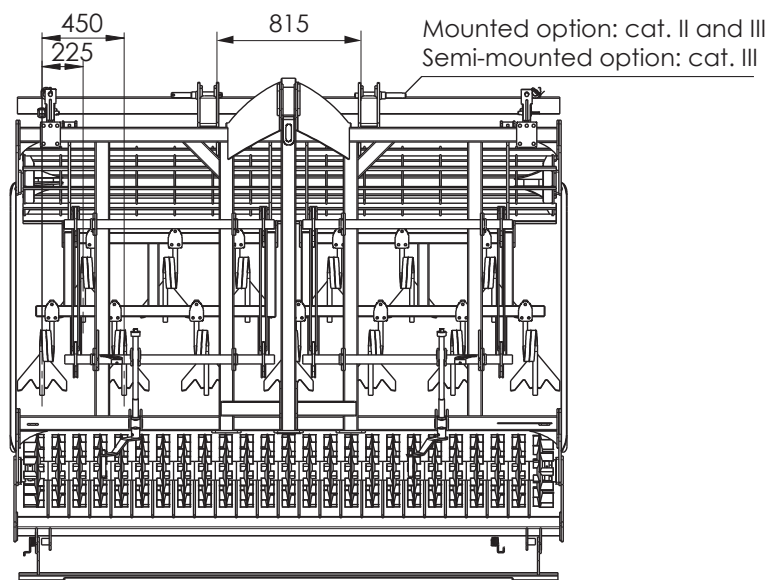
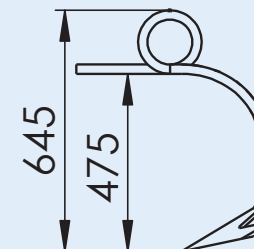

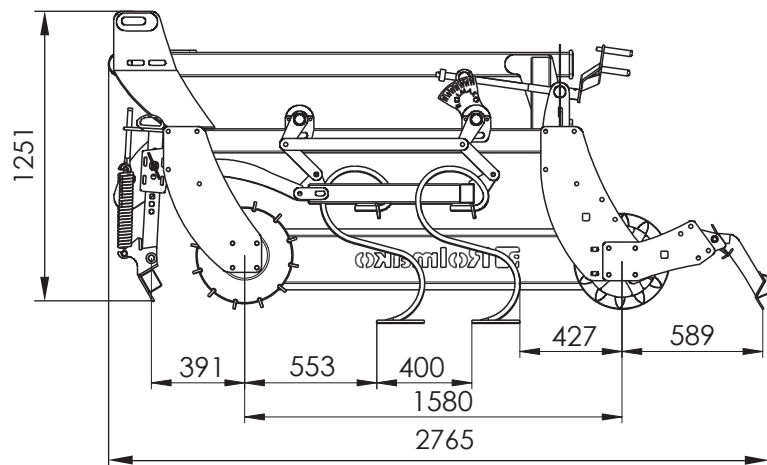

SX tine with reinforced double spring 50x10 mm, coulter 260 mm wide

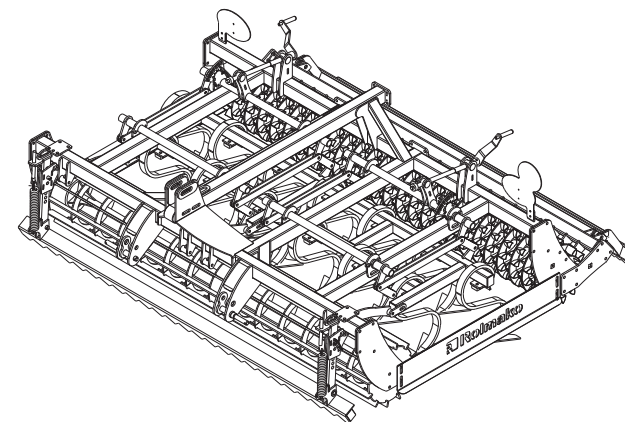
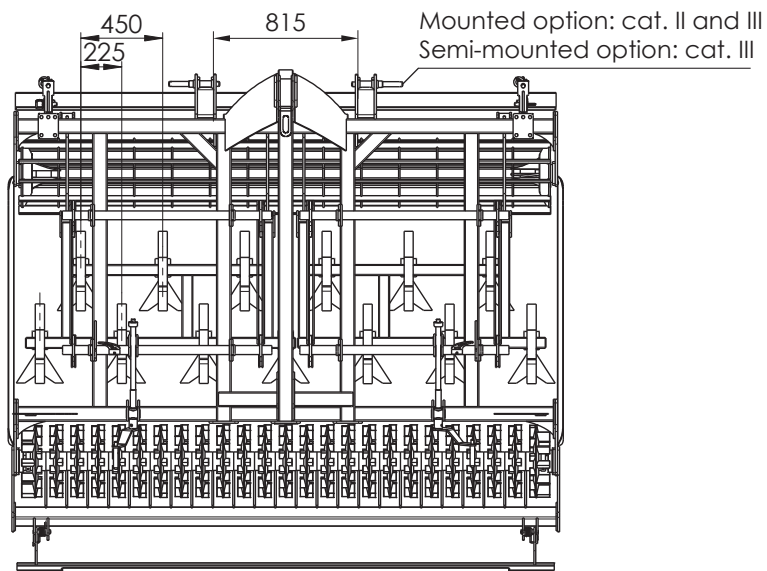
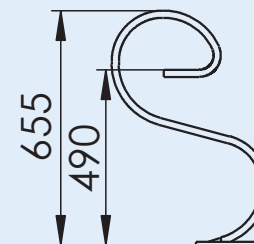

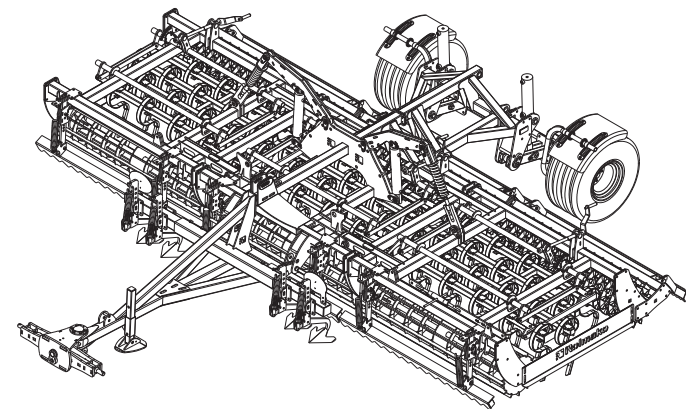
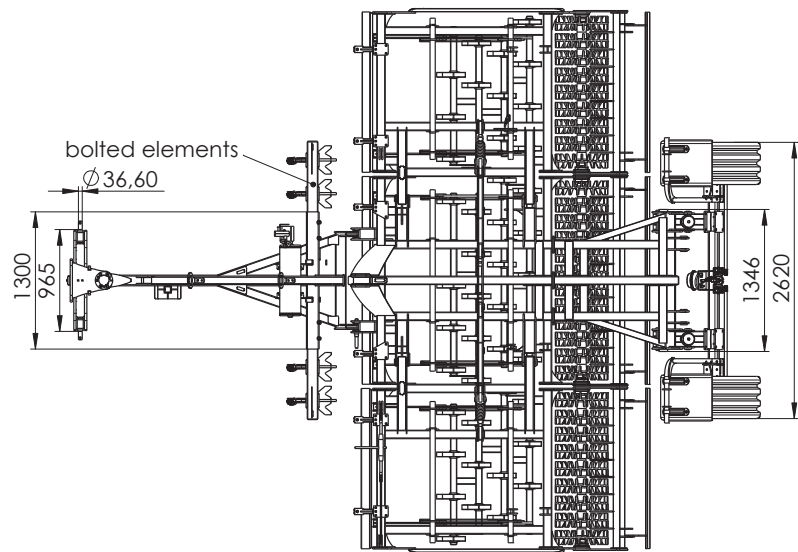
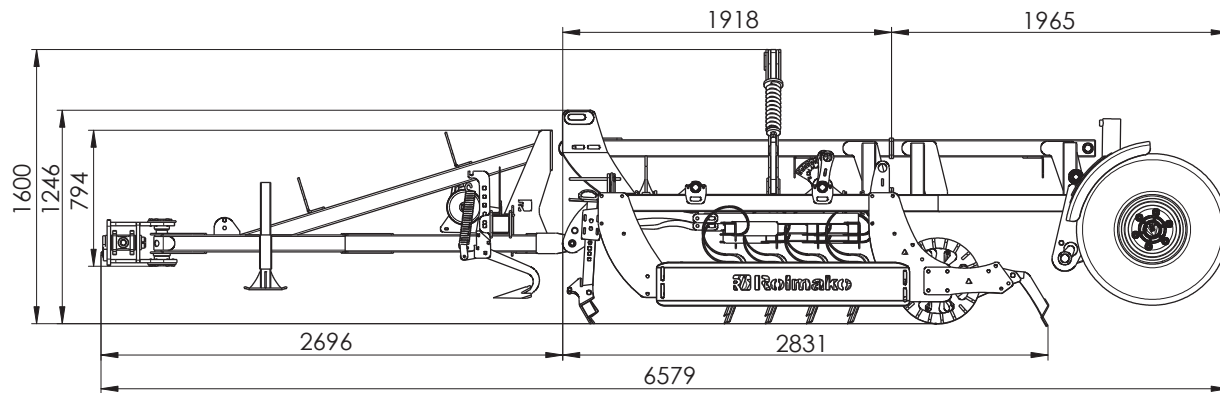

[www.rolmako.com](http://www.rolmako.com)

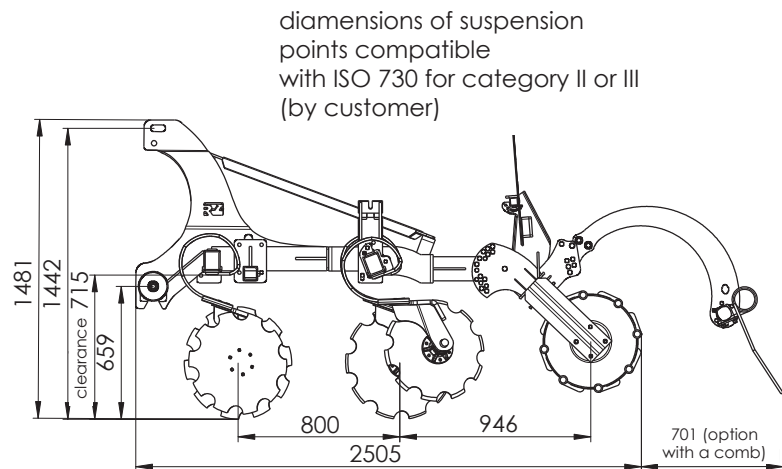

Nominal values of disc approach angles

The angle of inclination of the disc to the vertical



The angle of inclination of the disc to the driving direction

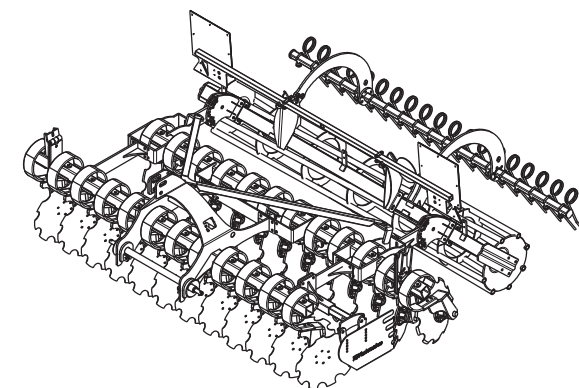
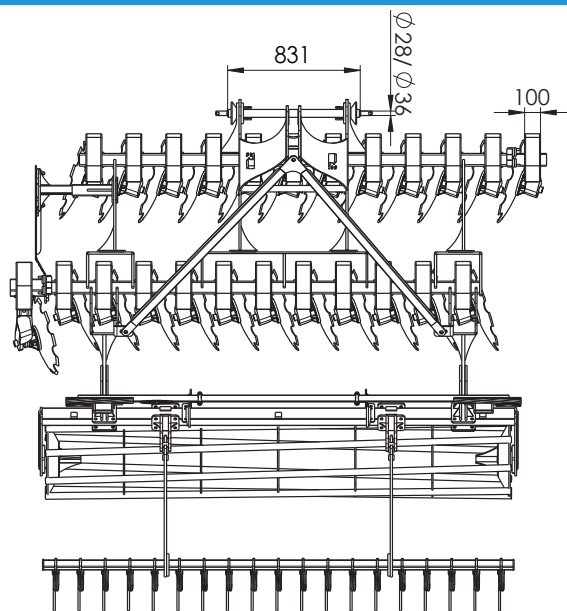



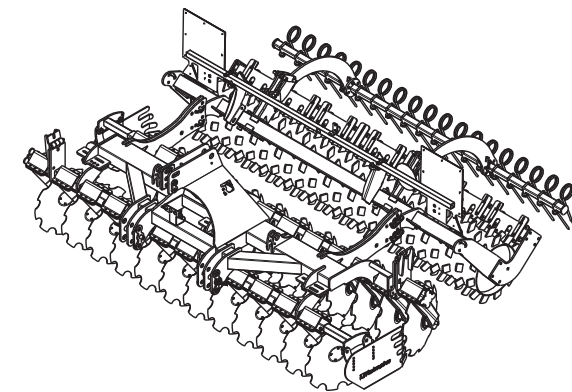
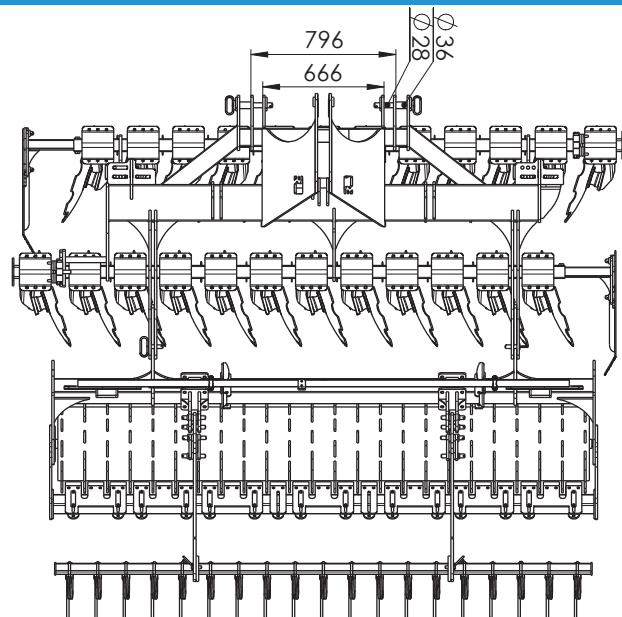
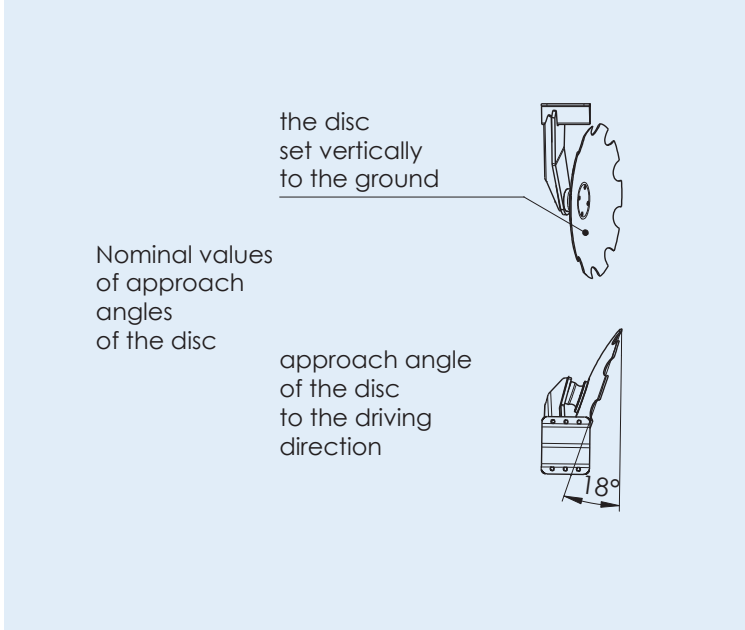
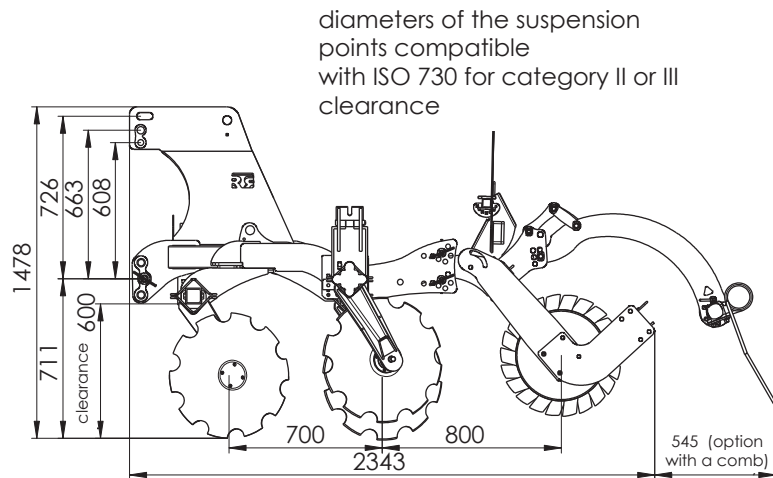

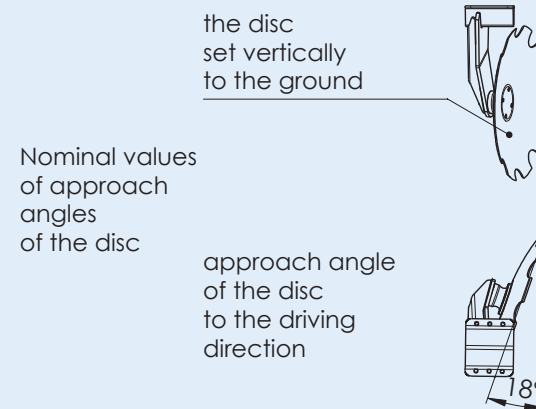
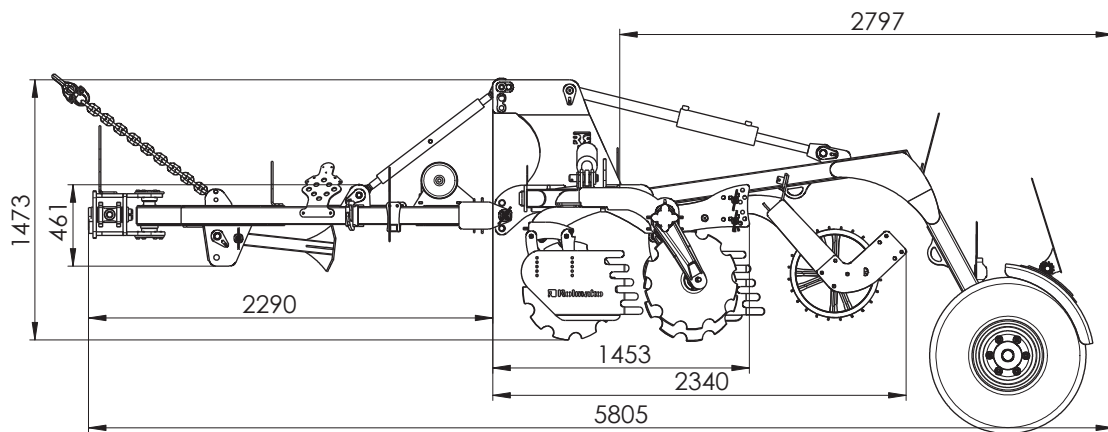

hitch system compatible with ISO 730 for category III

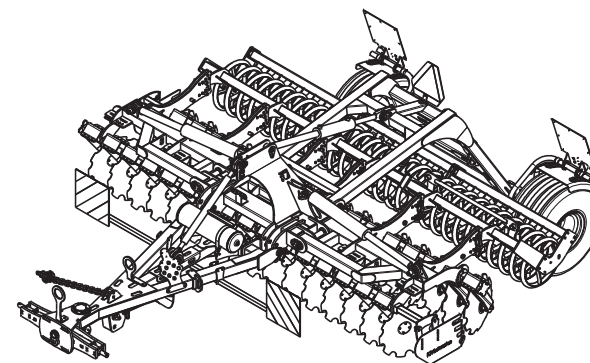
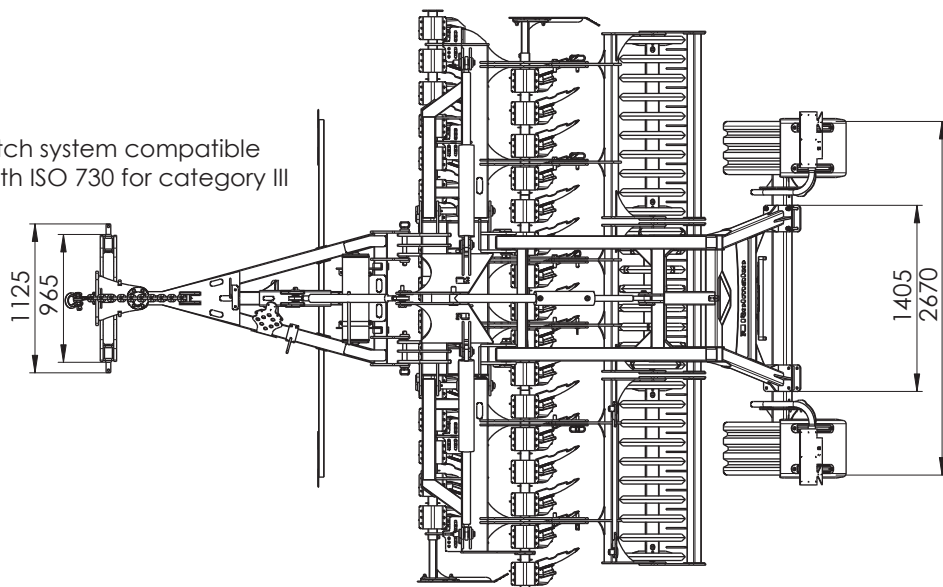

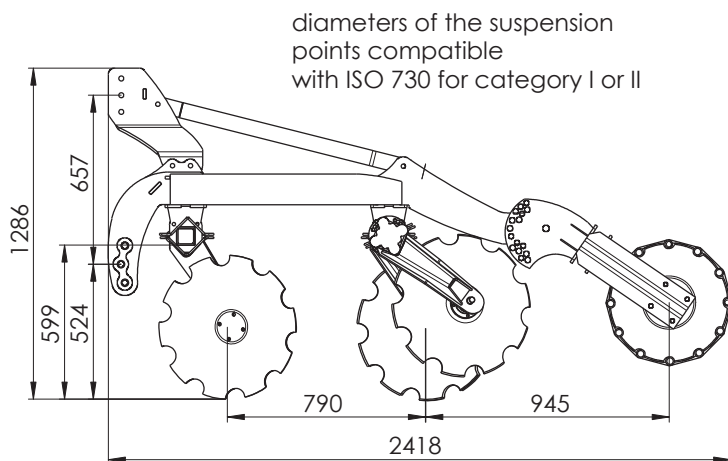

the disc set vertically to the ground

Nominal values of approach angles of the disc

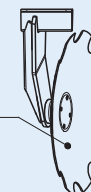

approach angle of the disc to the driving direction

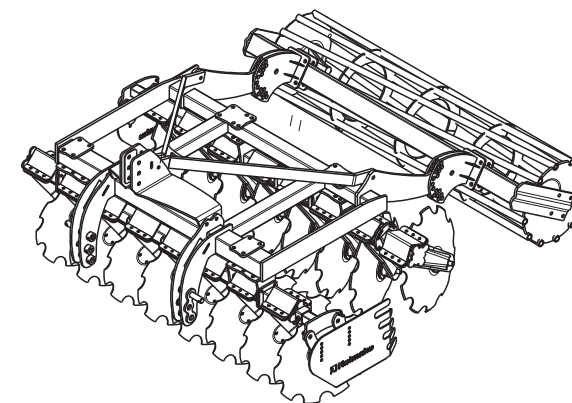
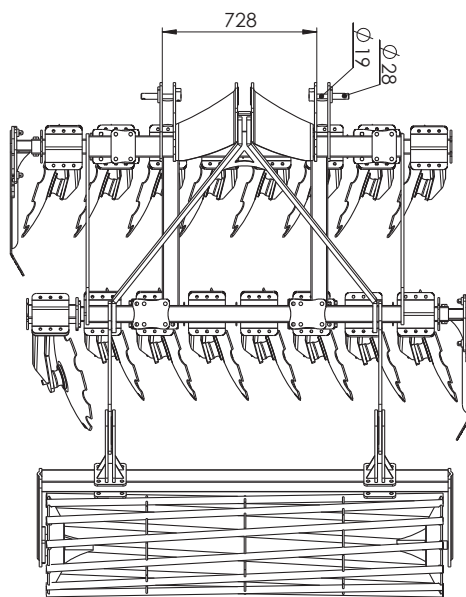

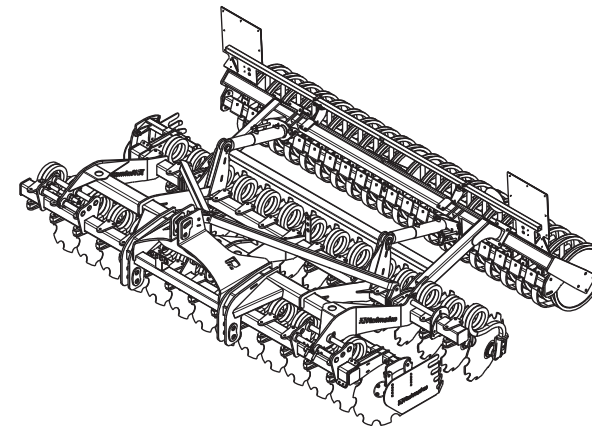
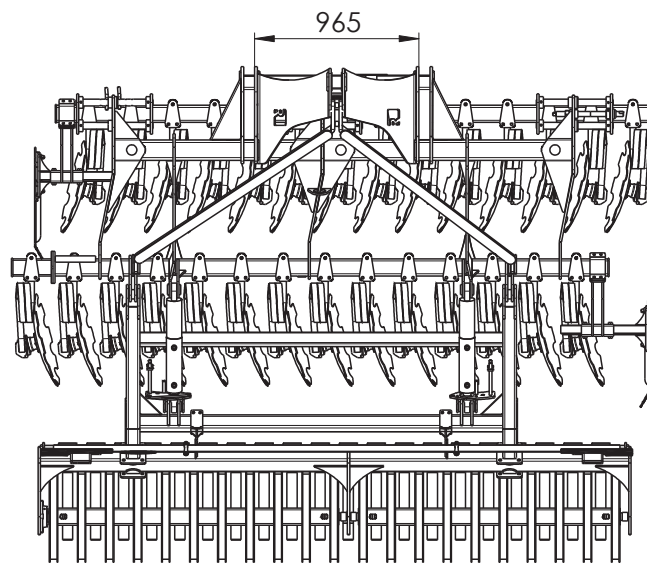
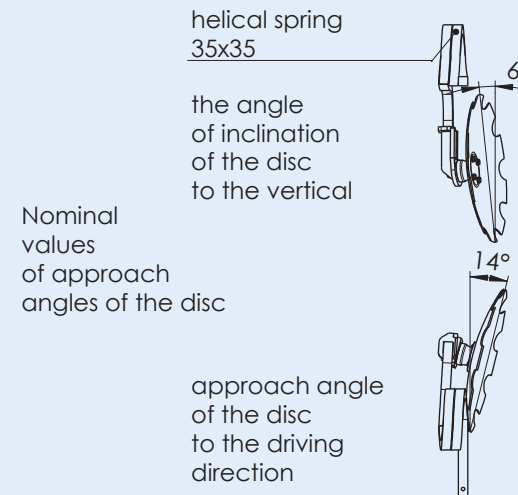
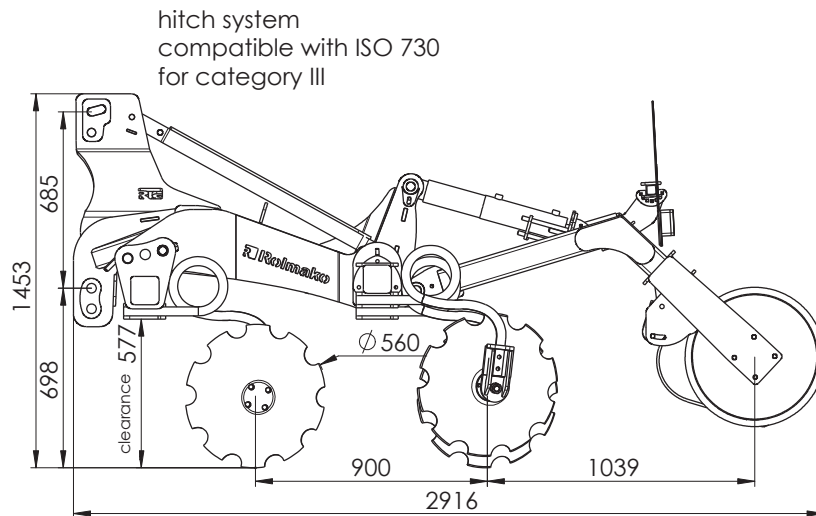

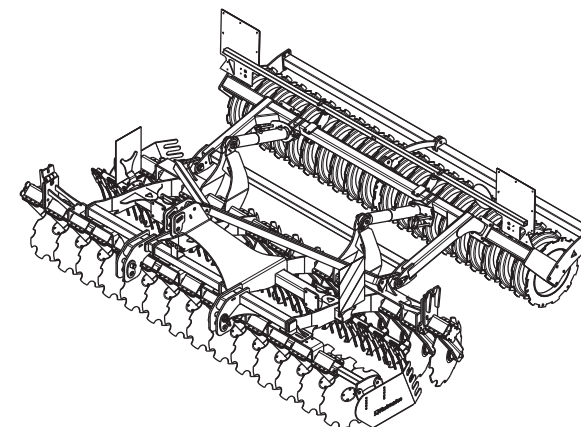
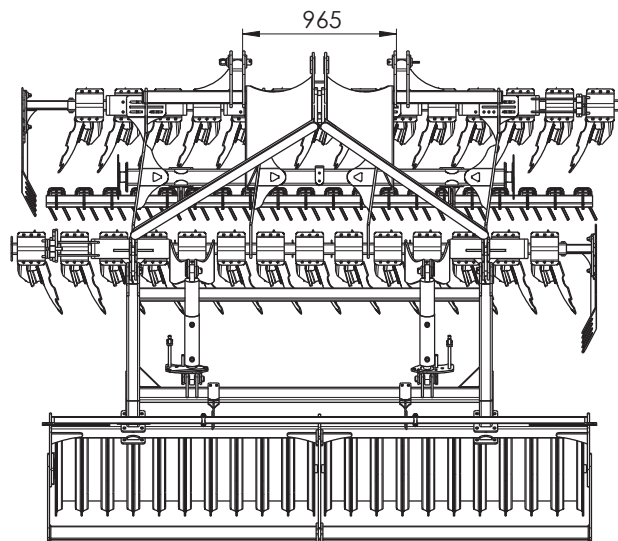
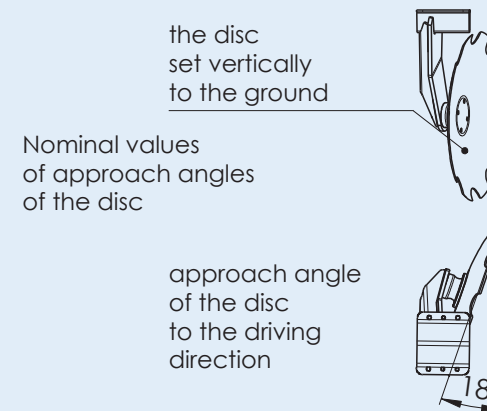
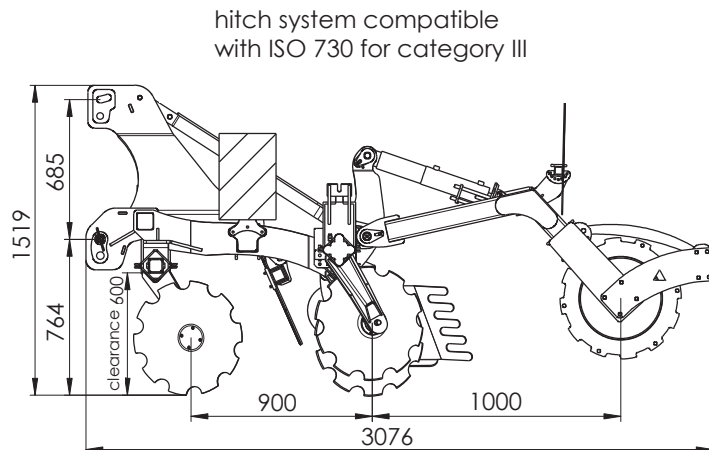

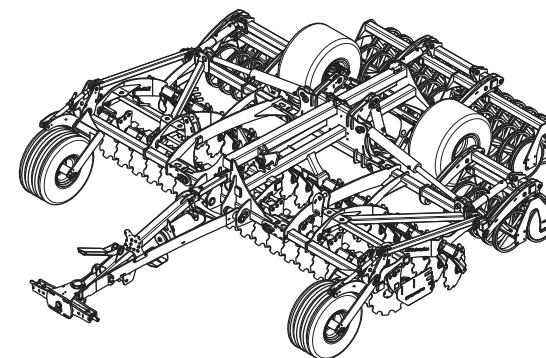
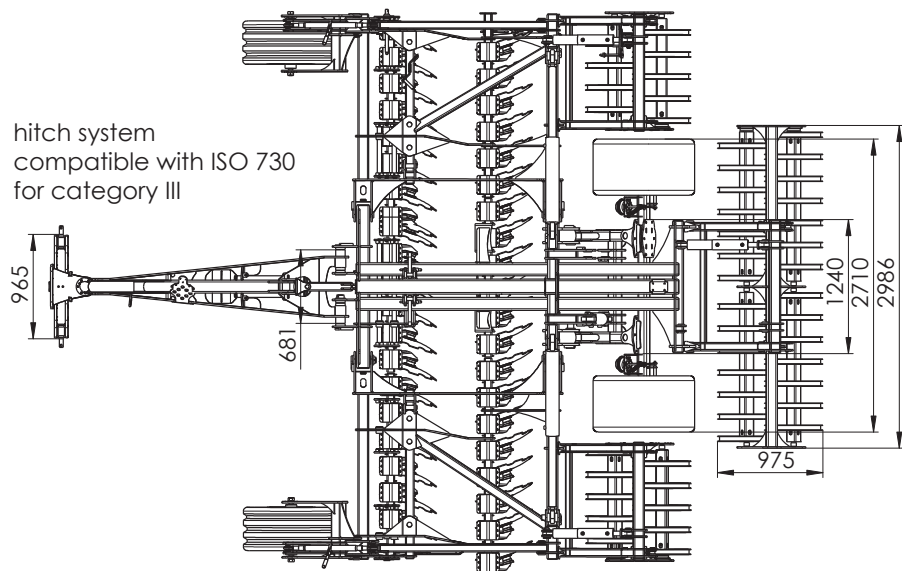
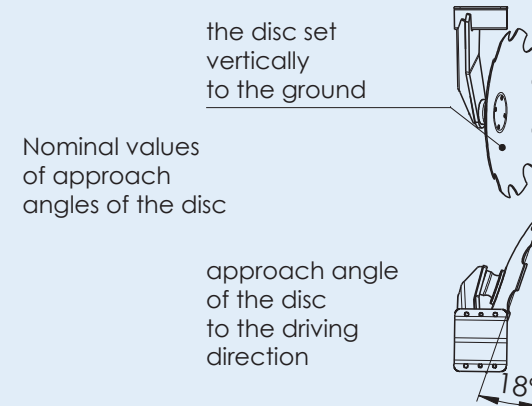
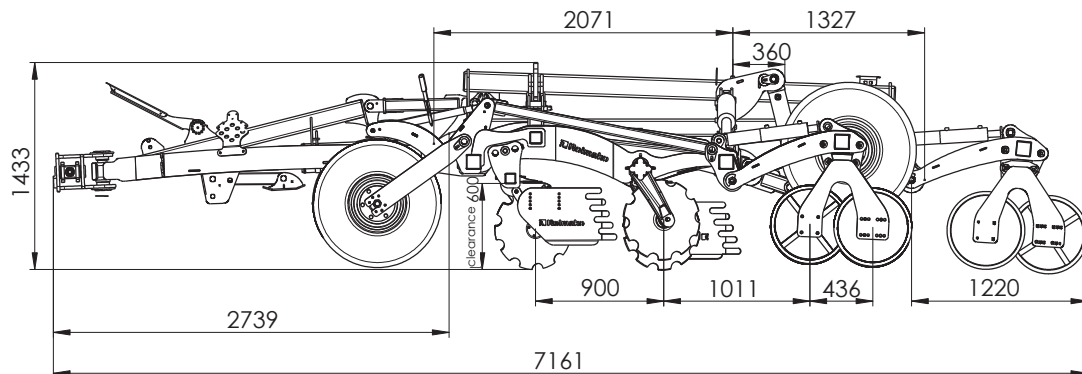

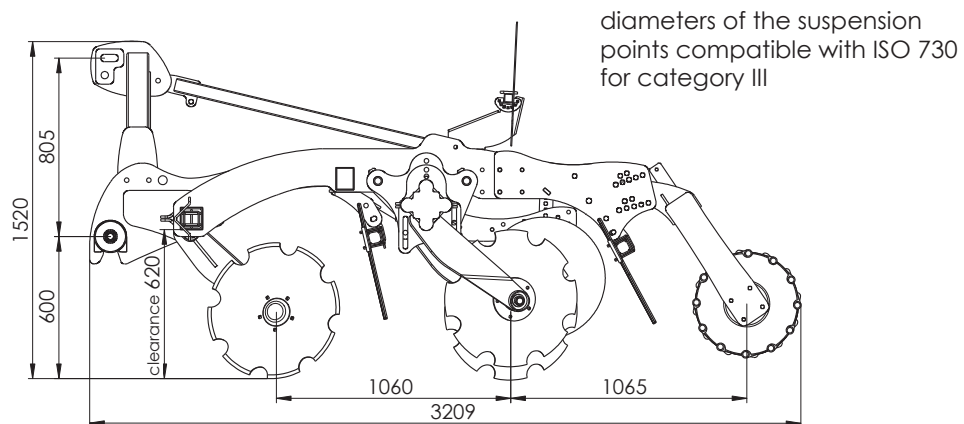

Nominal values of approach angles of the disc

The angle of inclination of the disc to the vertical

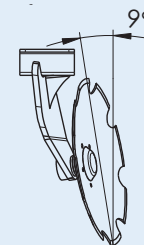

The angle of inclination of the disc to the driving direction

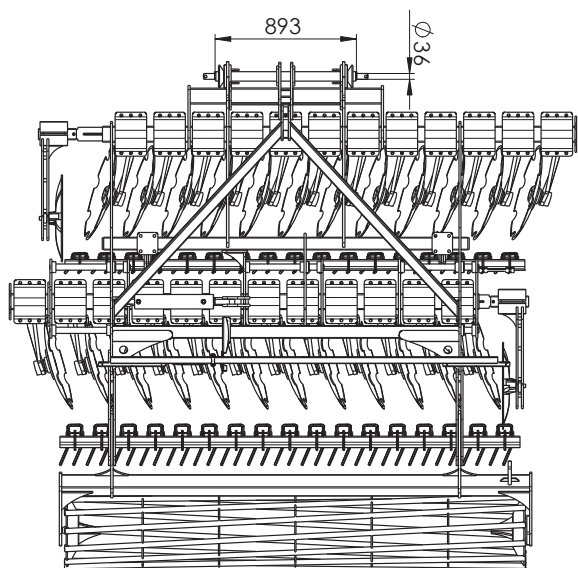
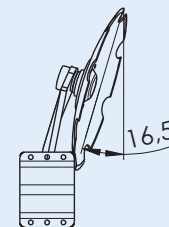

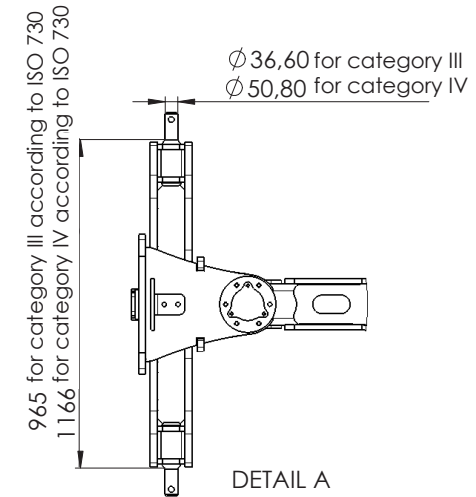
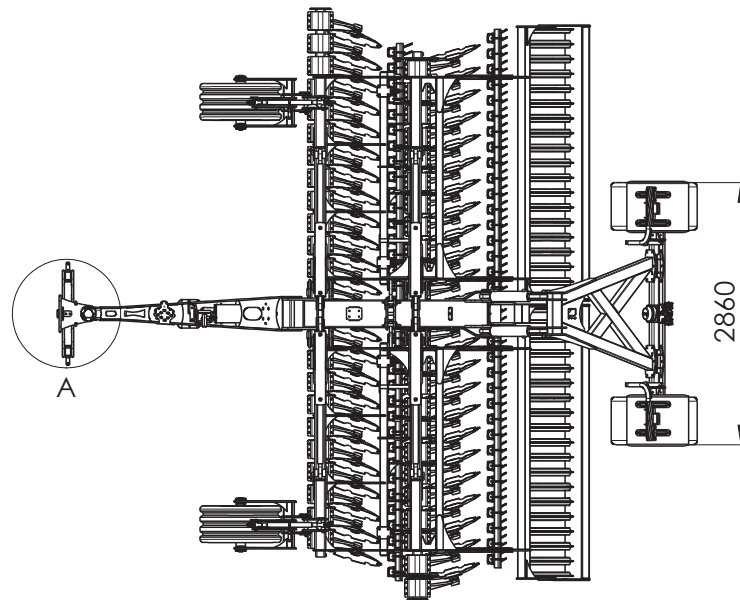
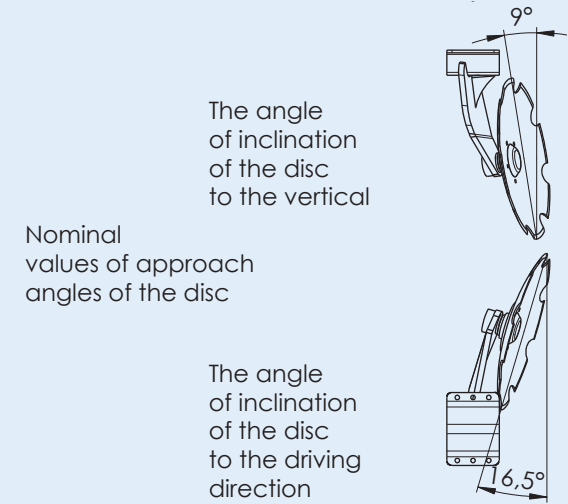
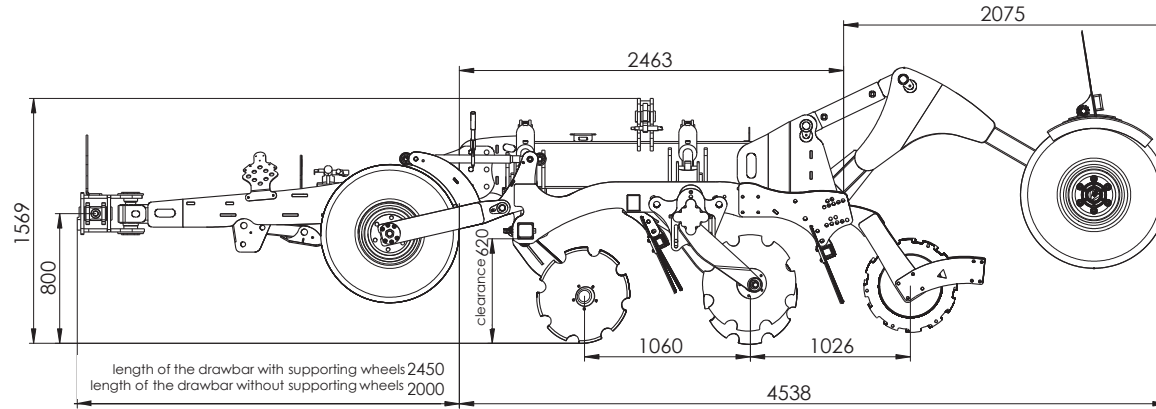



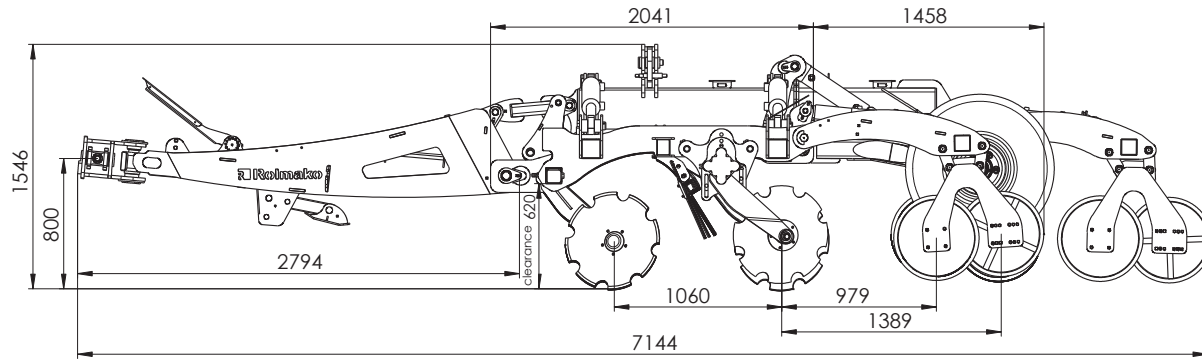

Nominal values of approach angles of the disc

The angle of inclination of the disc to the vertical

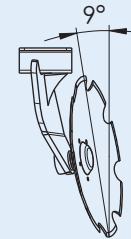

The angle of inclination of the disc to the driving direction

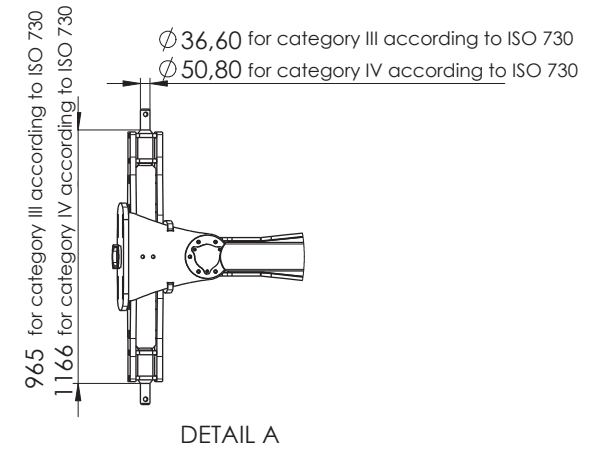
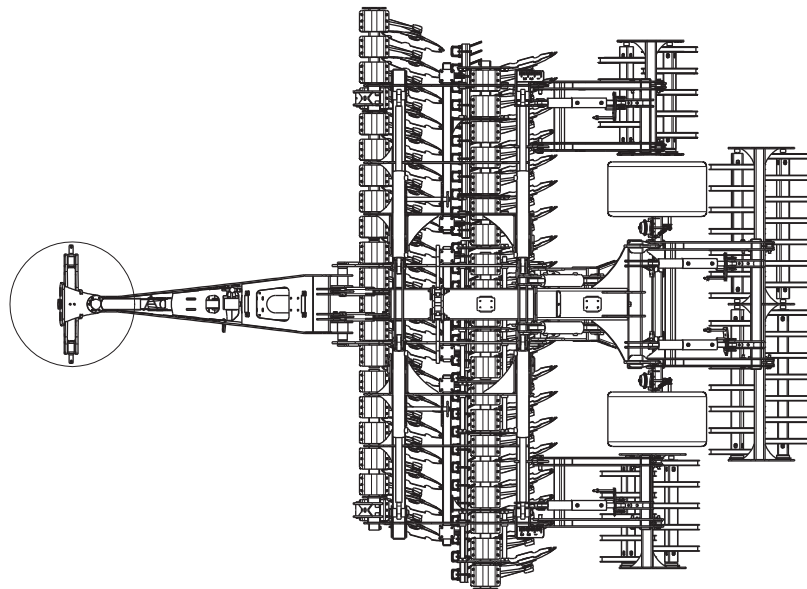
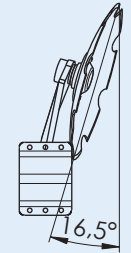

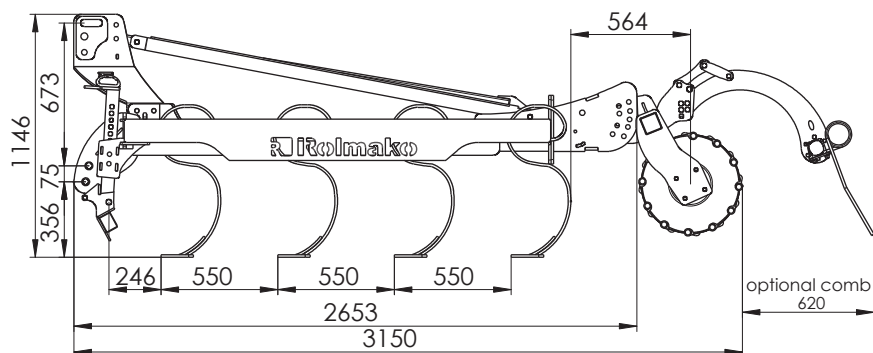

Caution!

- Diameters of the suspension points correspond to the category II and III according to ISO 730

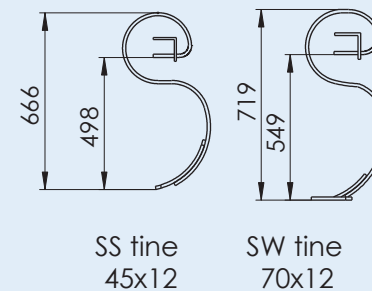

SS tine  
45x12

SW tine  
70x12

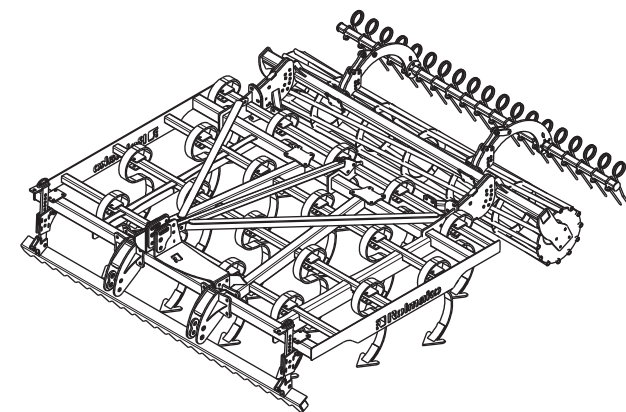
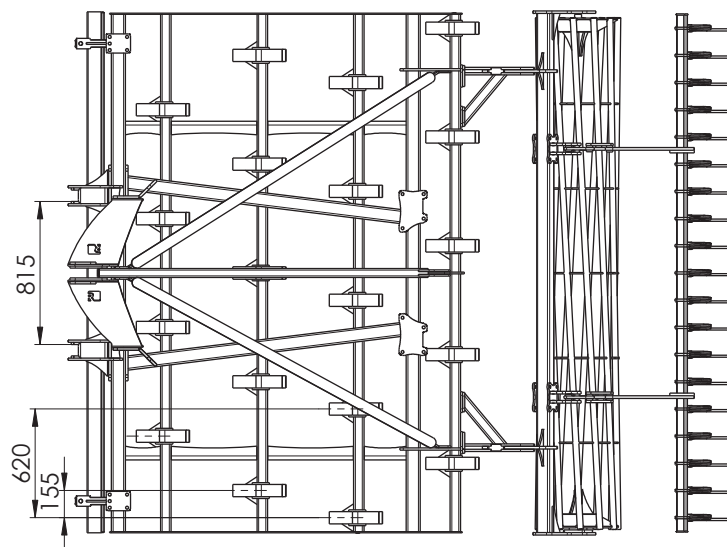

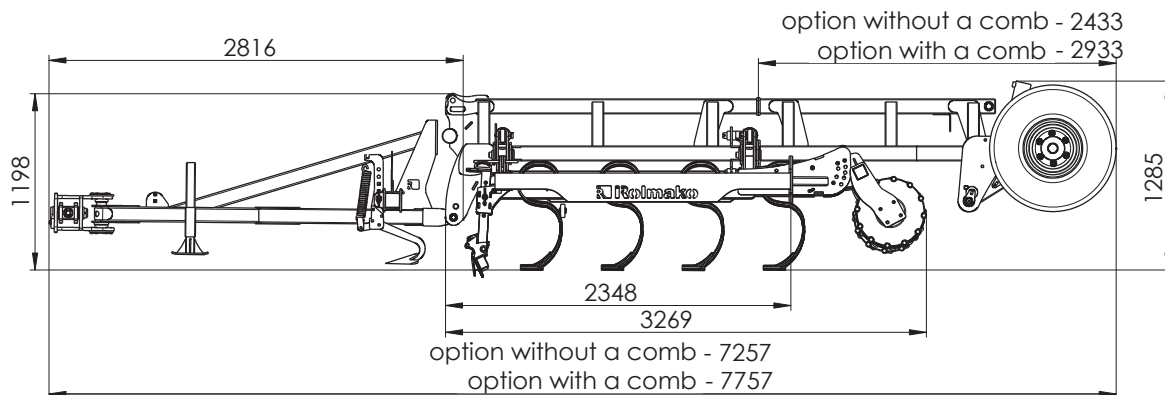

Caution!

- Diameters of the suspension points correspond to the category III according to ISO 730

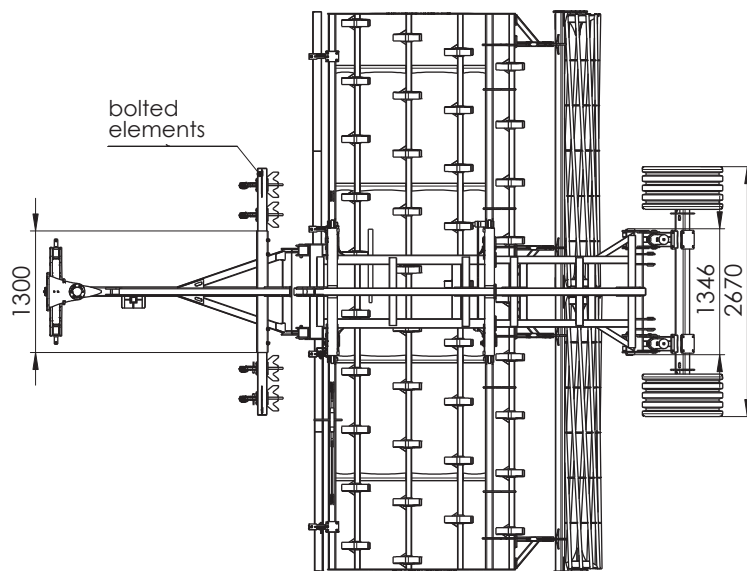
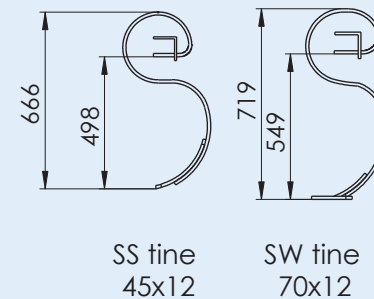

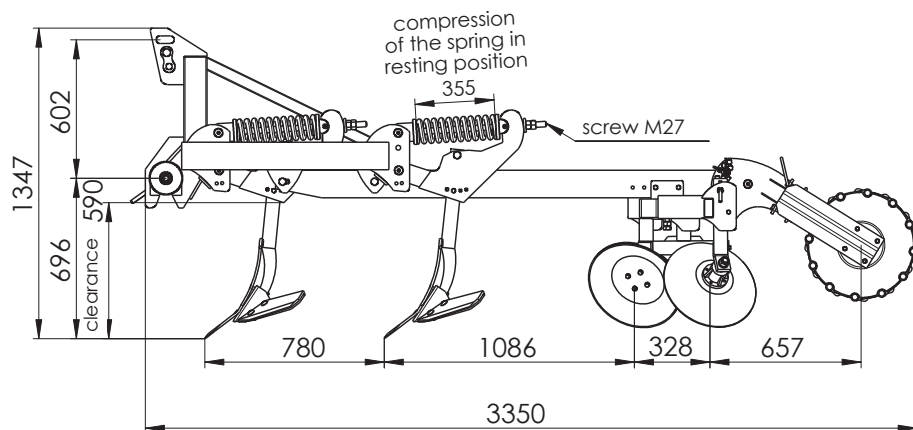

## Caution!

- Diameters of the suspension points correspond to category III according to ISO 730 (category II may also occur)
- Height dimensions refer to the option on the beam 750 mm (standard), Option GRUBBER Plus is equipped with the beam 835 mm

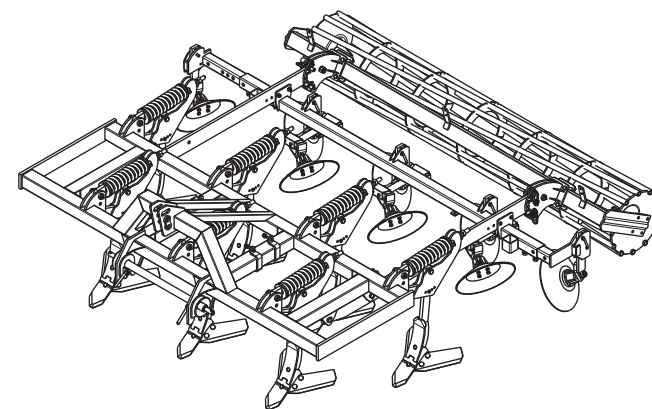
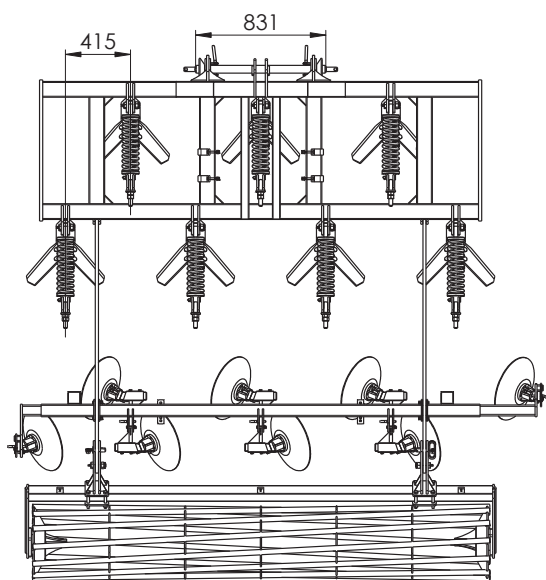

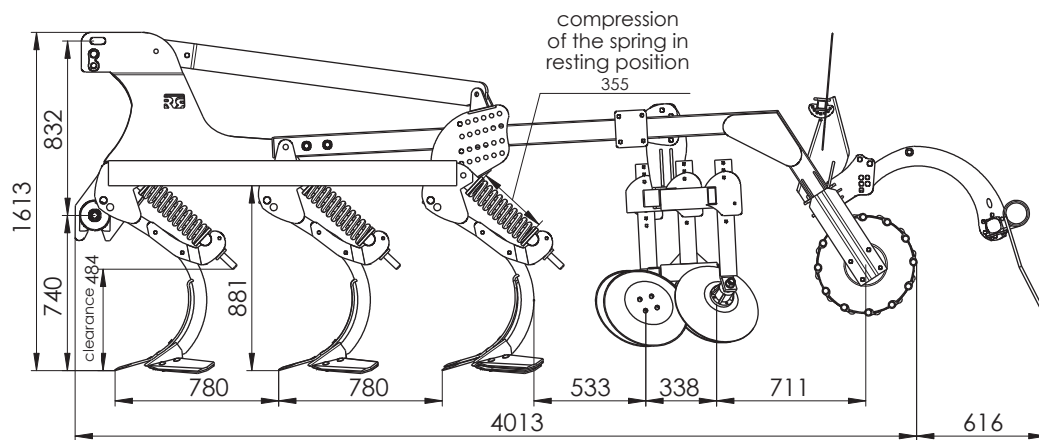
[www.rolmako.com](http://www.rolmako.com)

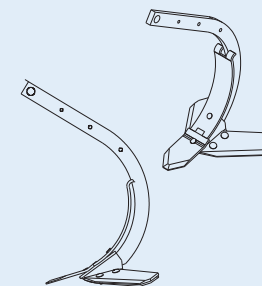

Caution!  
 Diameters of the suspension points correspond to category III according to ISO 730 (category II may also occur)

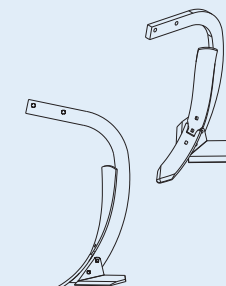

Delta tine



AgriFlex tine

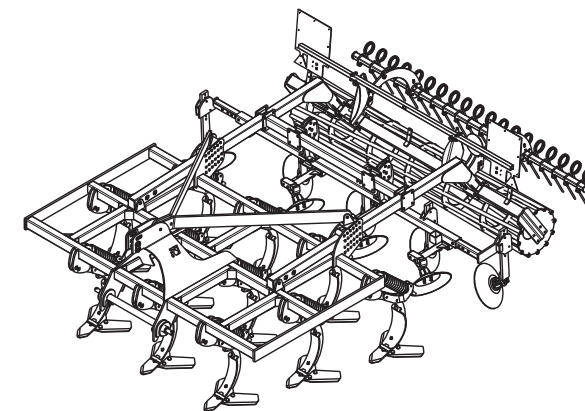
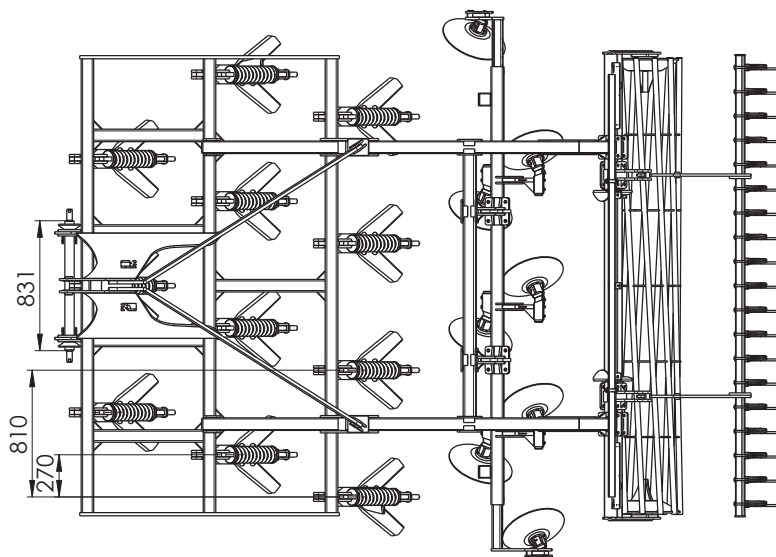

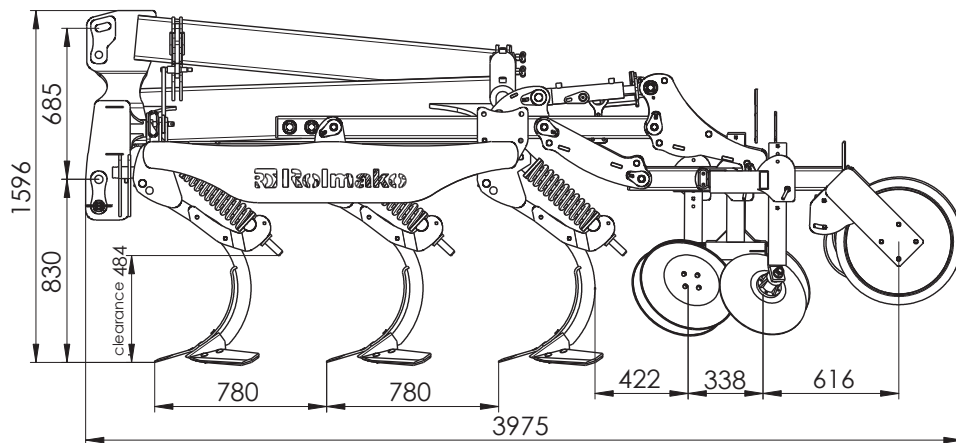

Caution!  
Diameters of the suspension points correspond to the category III according to ISO 730

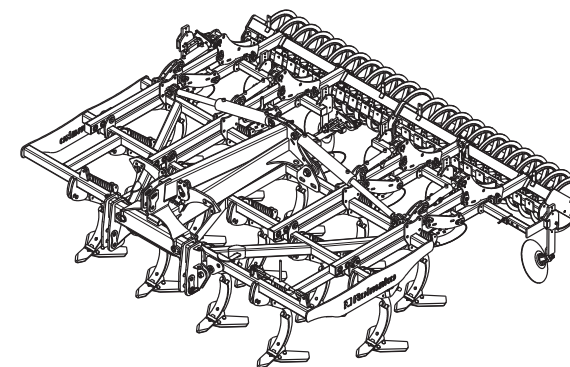
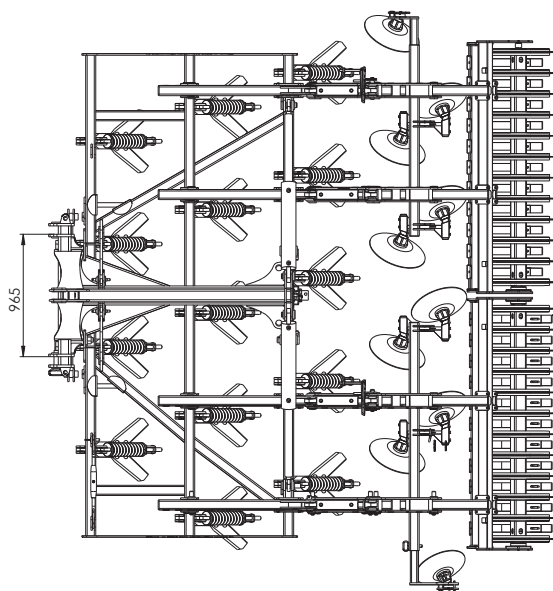
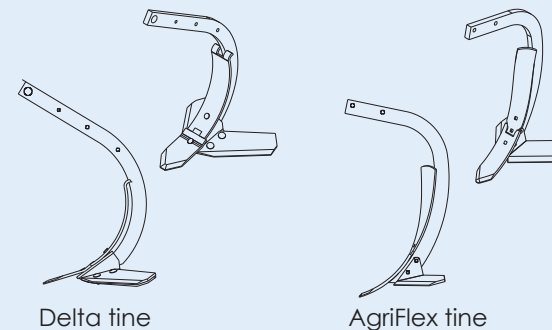

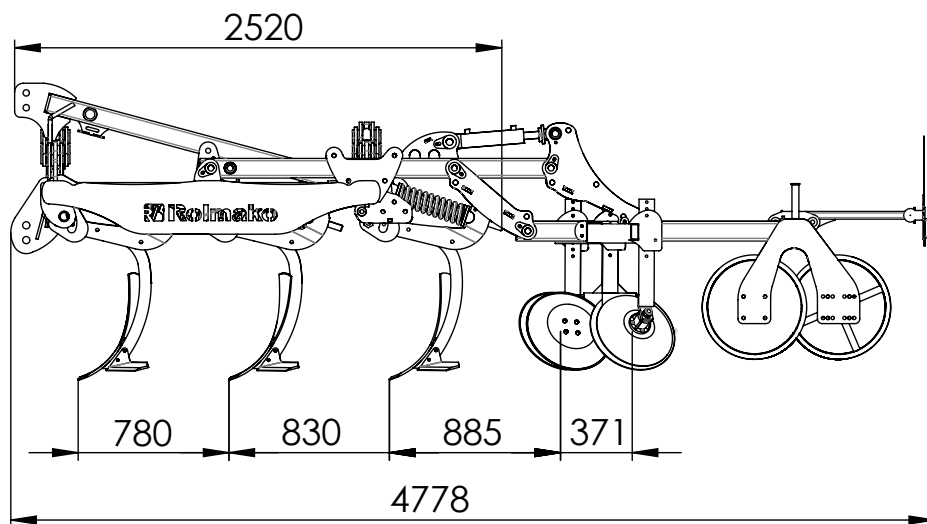

Caution!  
 Diameters of the suspension points correspond to the category III according to ISO 730

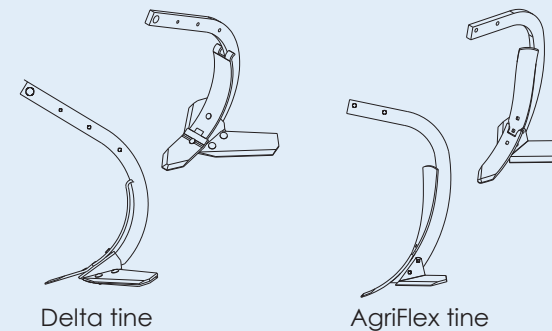

diameters of the suspension points compatible with ISO 730 for category III

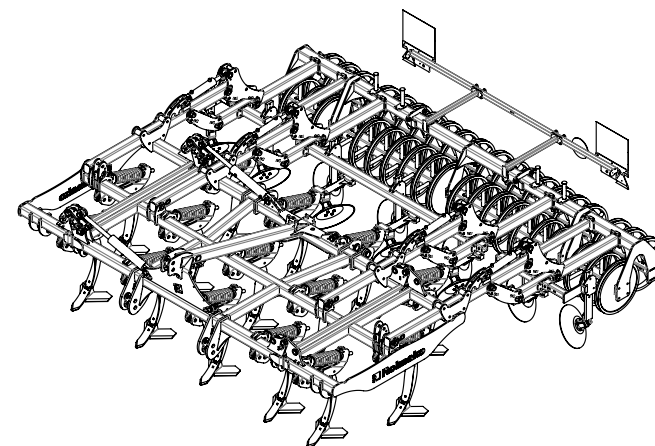
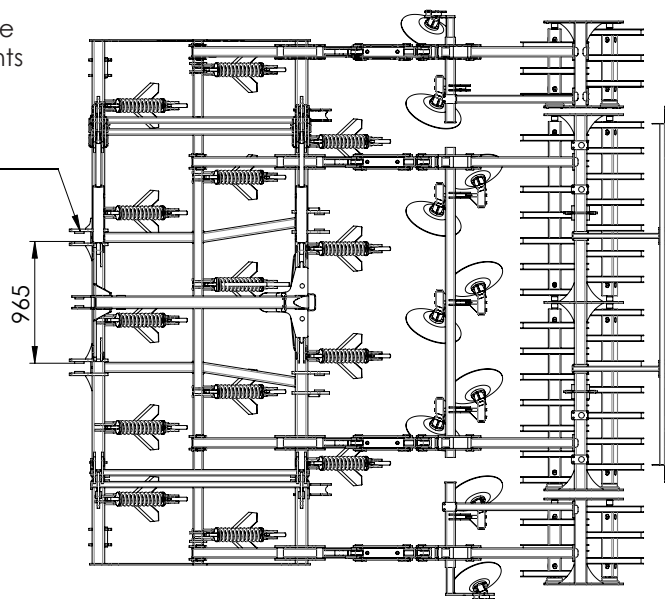

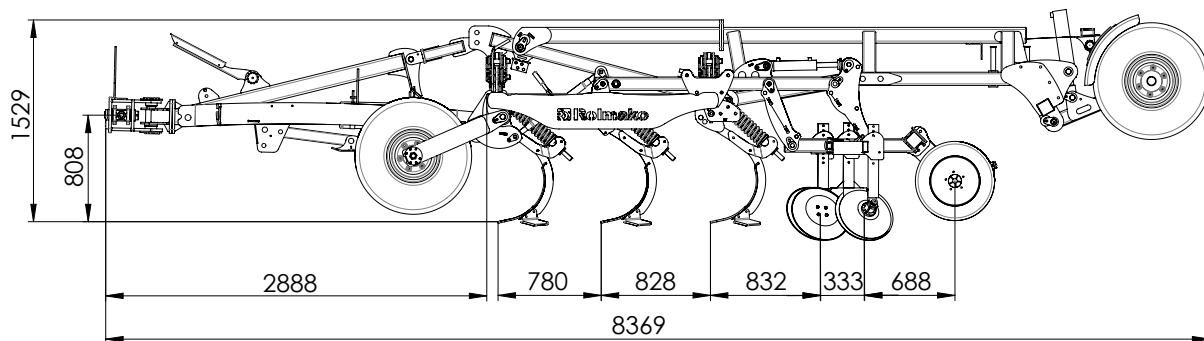

Caution!  
 Diameters of the suspension points correspond to the category III according to ISO 730

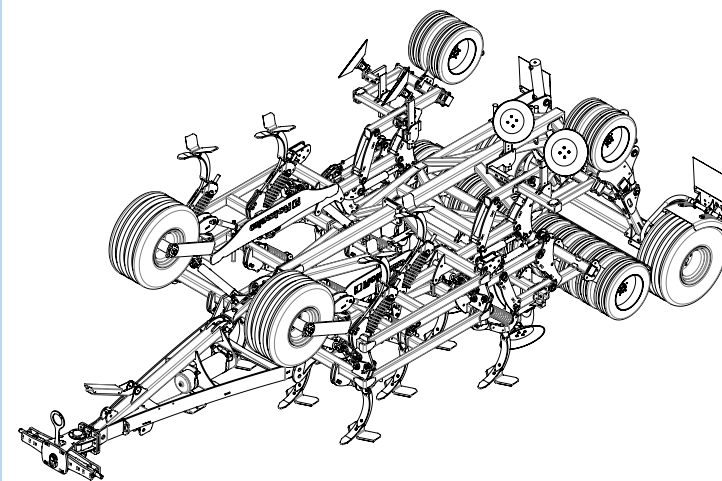
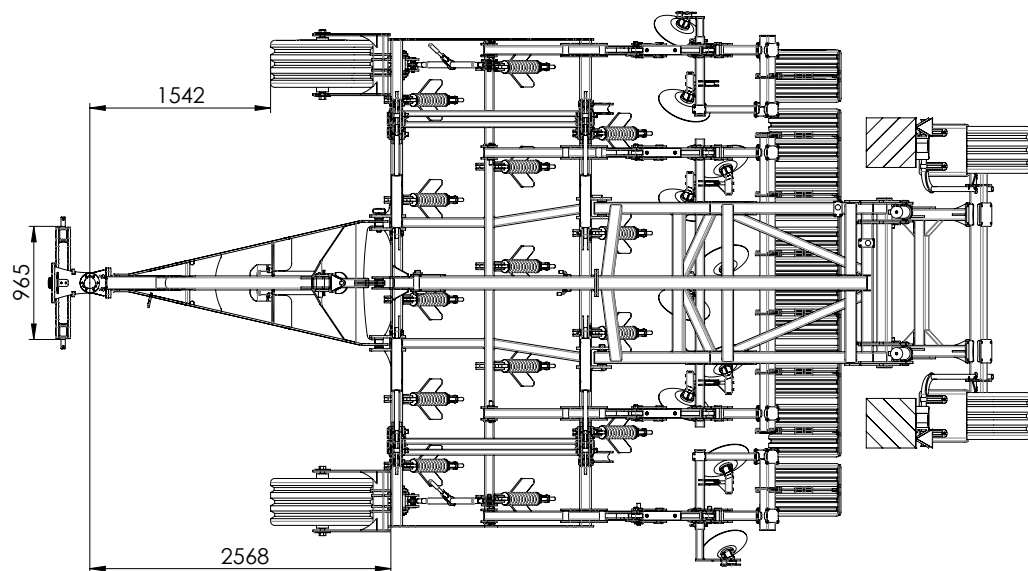
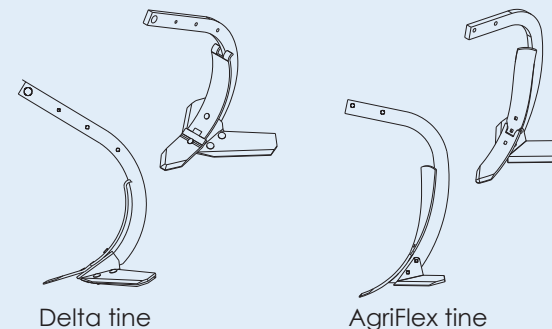



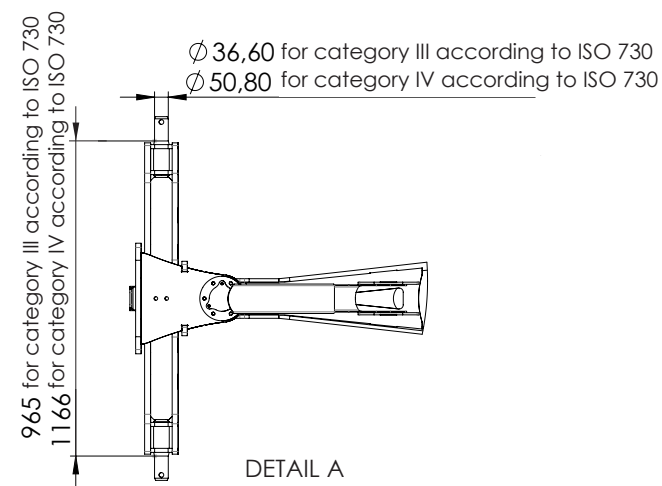
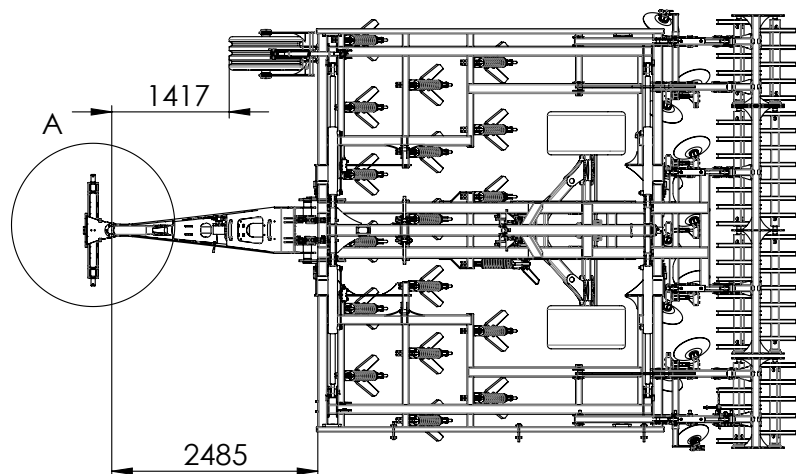
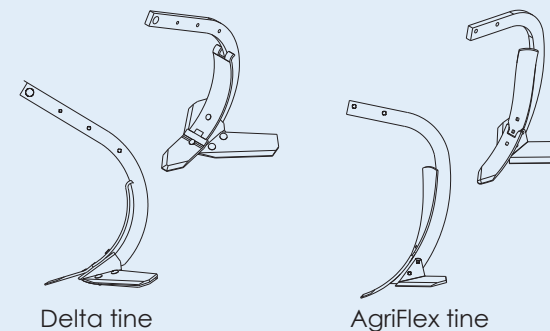
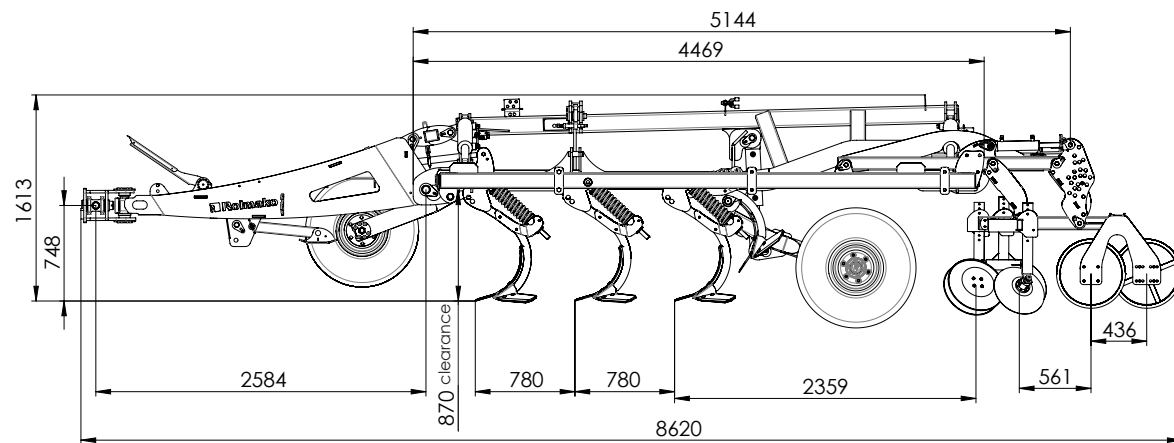

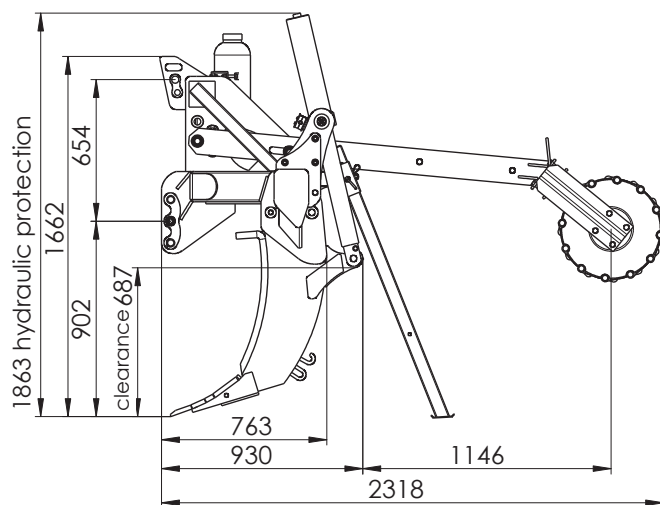

Caution!

Diameters of the suspension points correspond to:

- 1.6 / 3.0 m - category II and III according to ISO 730
- 3.8m - category III according to ISO 730

Types of tines

Straight tine with a chisel 100 mm

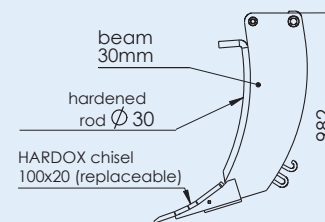

Straight tine with a chisel 300 mm

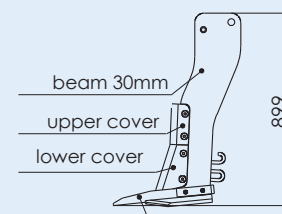

hardwearing chisel with undercutters

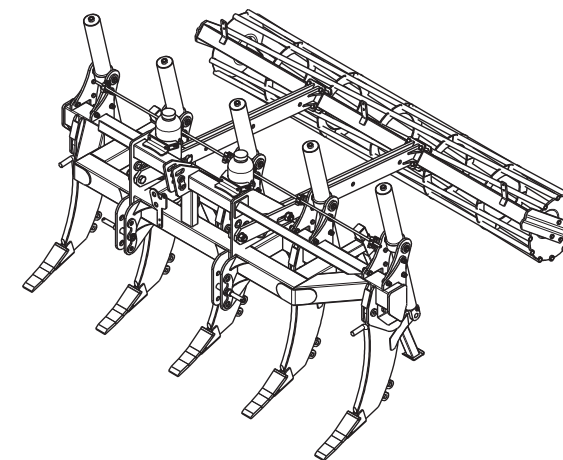
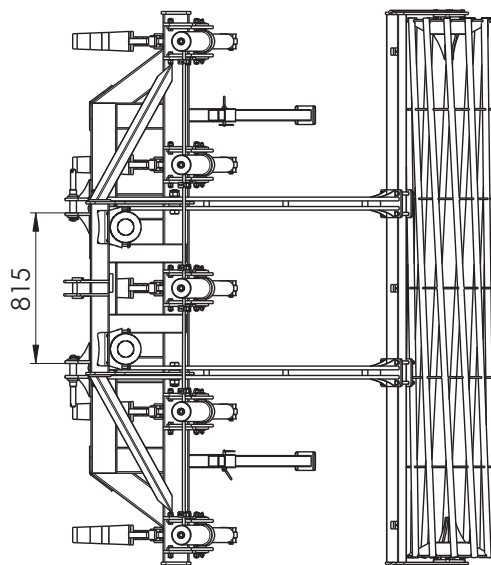

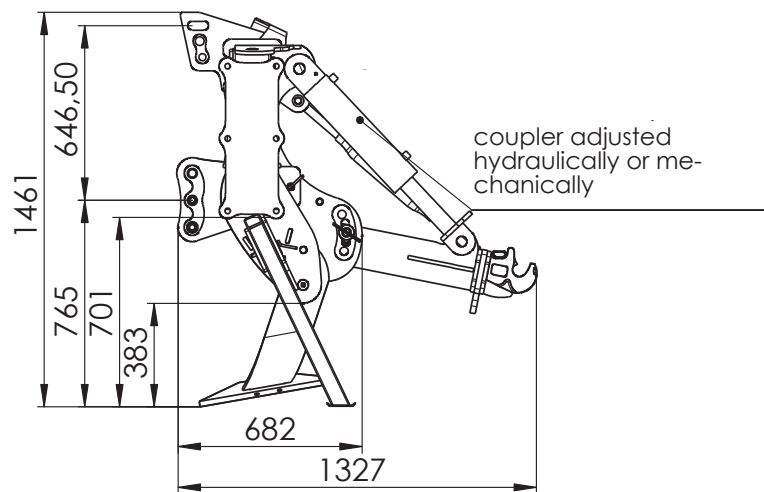

Caution!  
 Diameters of the suspension points correspond to:  
 category II and III according to ISO 730

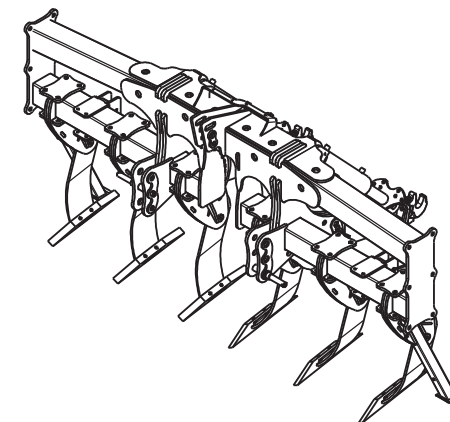
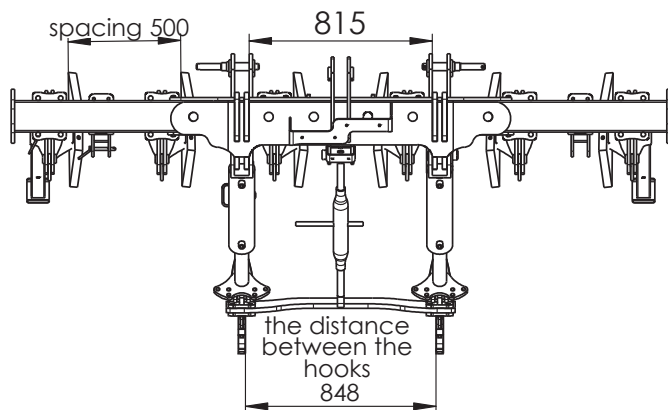
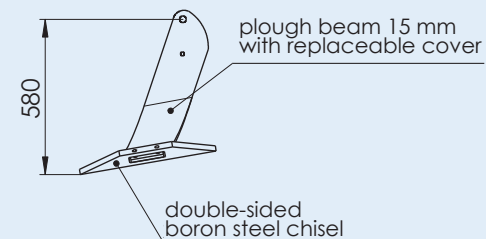

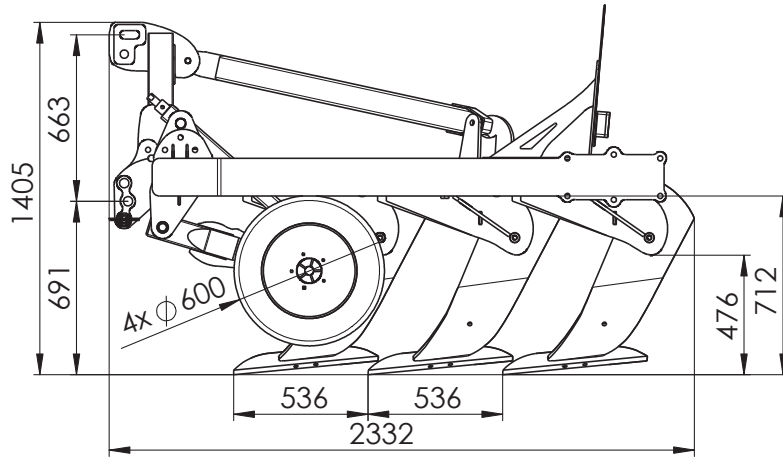

Caution!  
 Diameters of the suspension points correspond to:  
 category III according to ISO 730

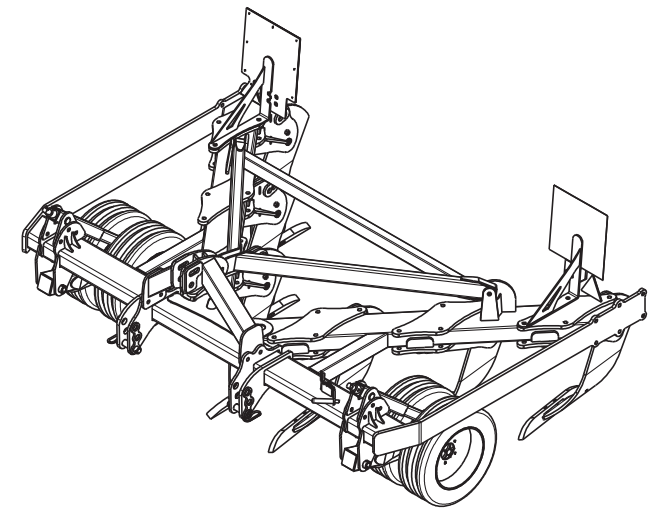
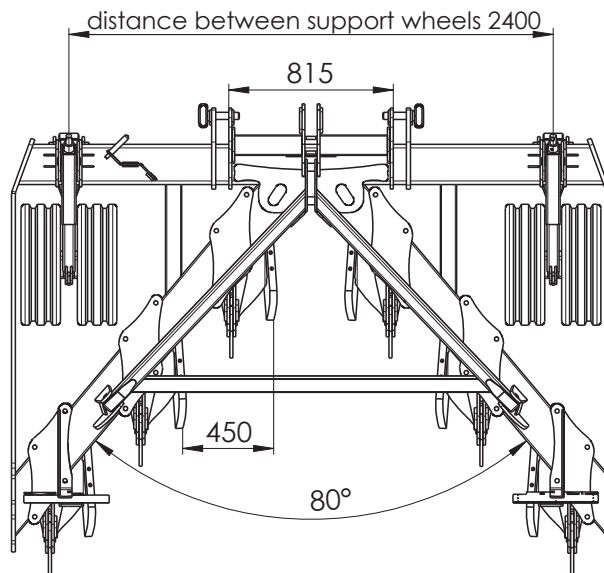
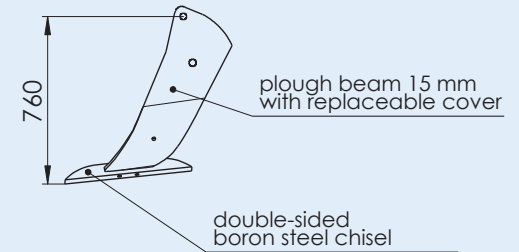

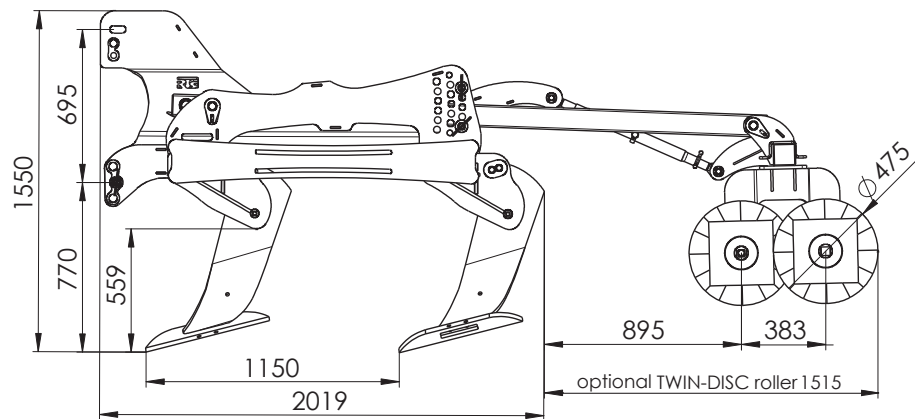

Caution!  
 Diameters of the suspension points correspond to:  
 category III according to ISO 730

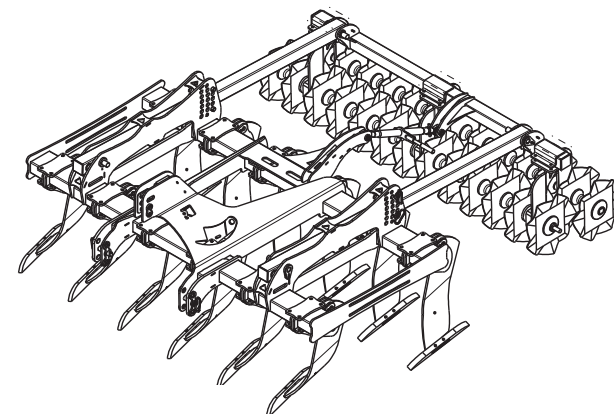
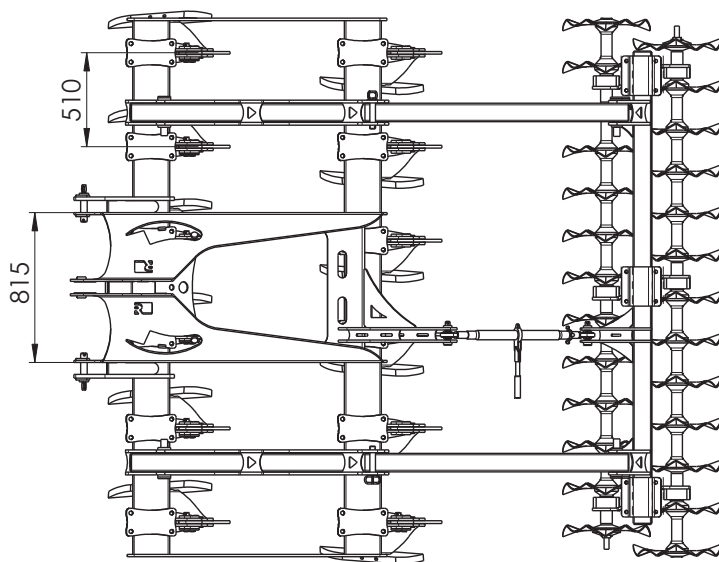
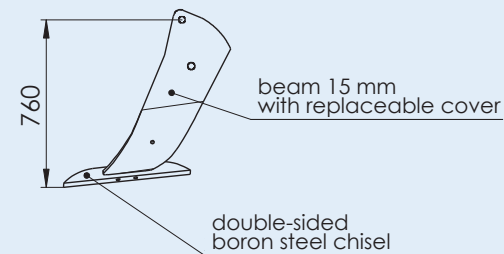

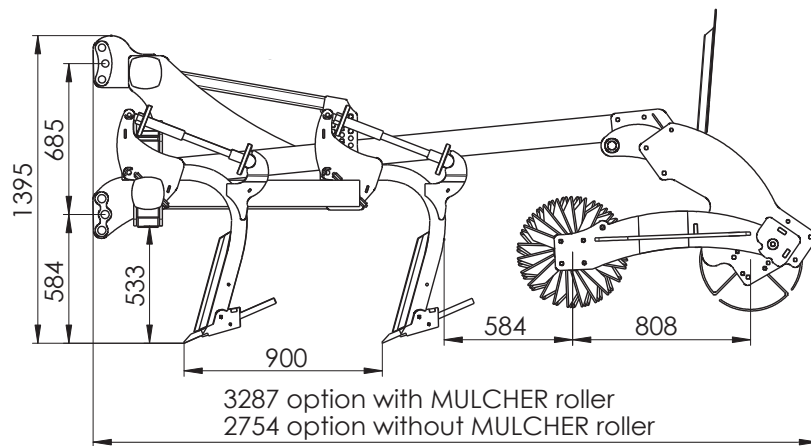

Caution!  
 Diameters of the suspension points correspond to:  
 category II and III according to ISO 730

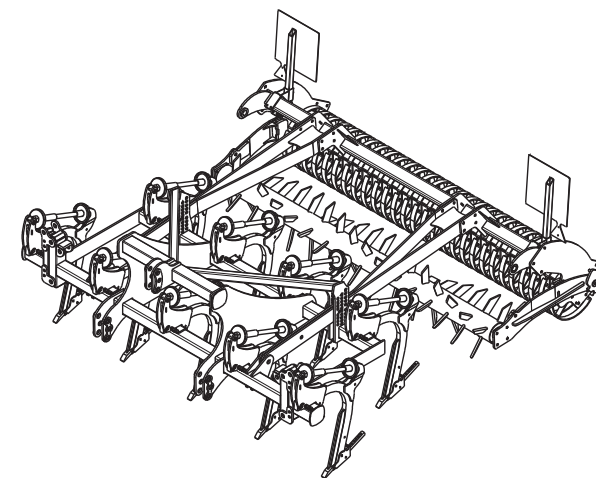
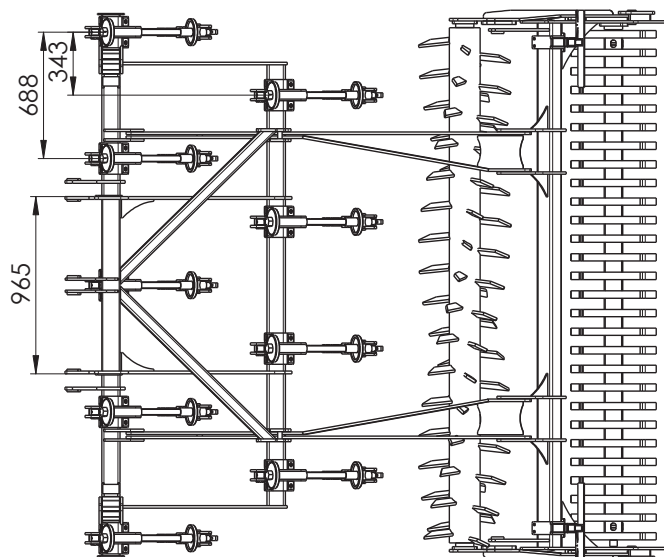
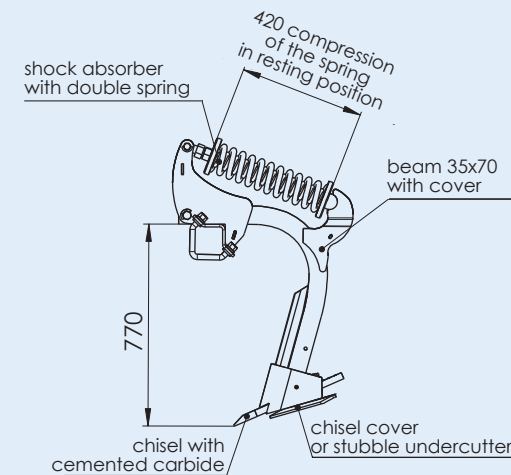

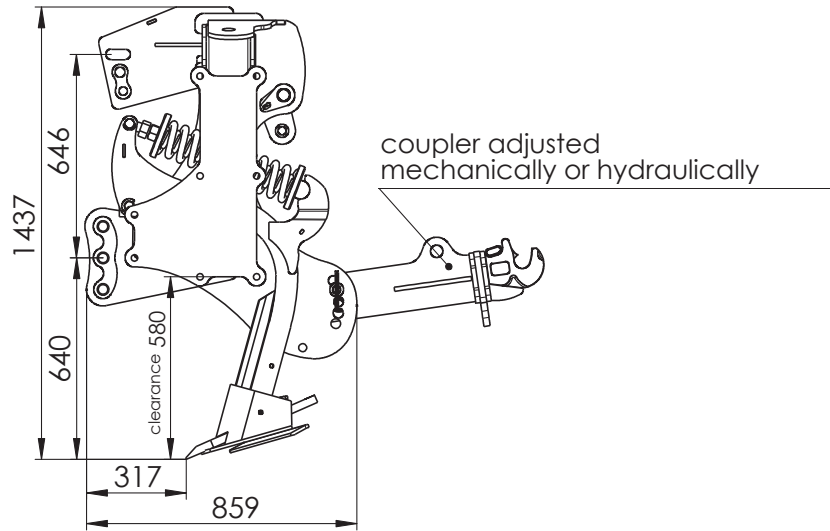

Caution!  
 Diameters of the suspension points correspond to:  
 category II and III according to ISO 730

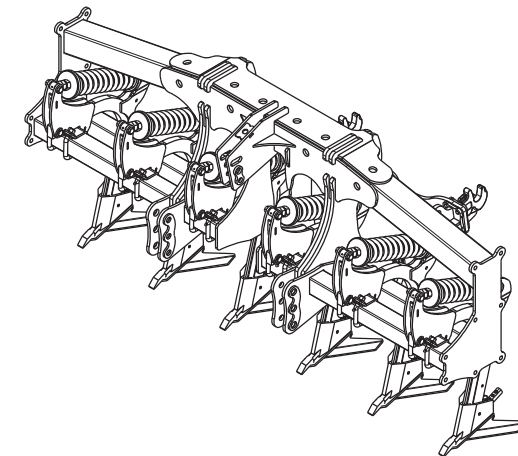
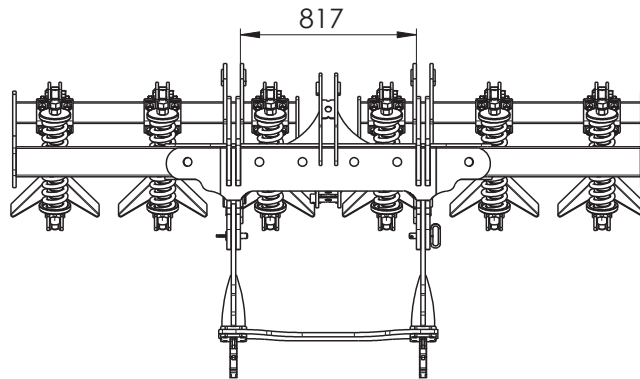
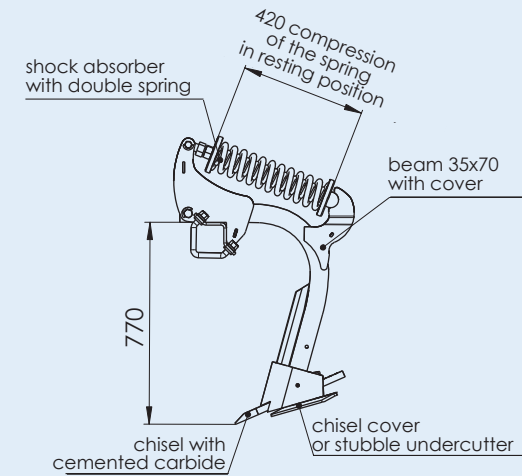

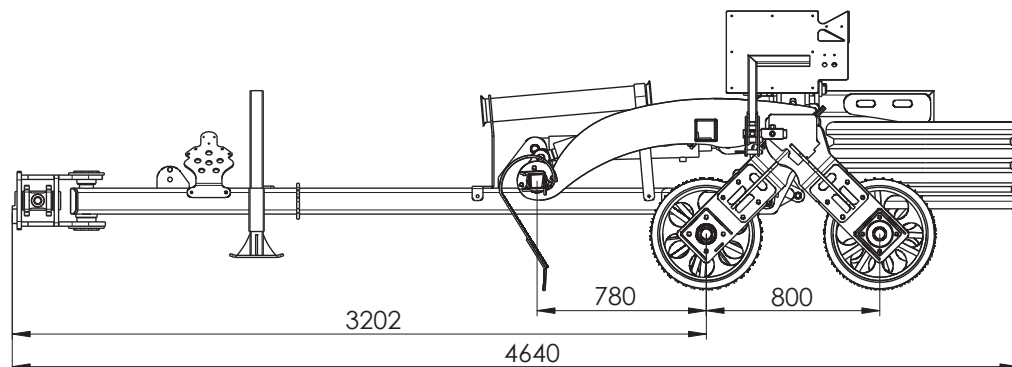

Prismatic roller  
ø500

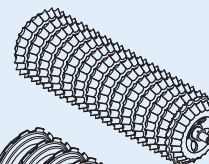

Crosskill  
ø500

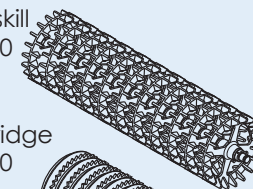

Steel ring roller  
ø600

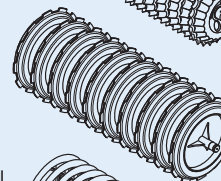

Cambridge  
ø530

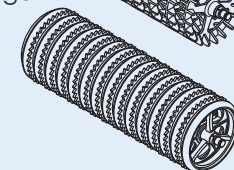

Campbell  
ø560/700

